

VIA RAIL CANADA INC.
RAIL CORRIDOR

FUTURE COMMERCIAL BLDG. - SITE DATA

SITE ZONING:	T.B.D.
PROPOSED LOT AREA =	33,861 SQ.M. (3.38 HECTARES)
PROPOSED NEW BUILDING	9,357 SQ.M.
BUILDING FOOTPRINT (LOT COVERAGE) =	9,357 SQ.M. (27.63%)
LANDSCAPE AREA PROVIDED 10.14% =	3,431 SQ.M.
TOTAL PARKING PROVIDED =	418 SPACES INC. 16 H/C

PROPOSED COMMERCIAL BUILDING - SITE DATA

SITE ZONING:	T.B.D.
PROPOSED LOT AREA =	79,126 SQ.M. (7.91 HECTARES)
PROPOSED NEW BUILDING	15,071 SQ.M.
BUILDING FOOTPRINT (LOT COVERAGE) =	15,071 SQ.M. (19.04%)
LANDSCAPE AREA PROVIDED 11.92% =	9,435 SQ.M.
TOTAL PARKING PROVIDED =	967 SPACES INC. 16 H/C

FUTURE
1-STOREY
COMMERCIAL
BUILDING
AREA 9,357 SQ.M.
PRKG: 418 STALLS

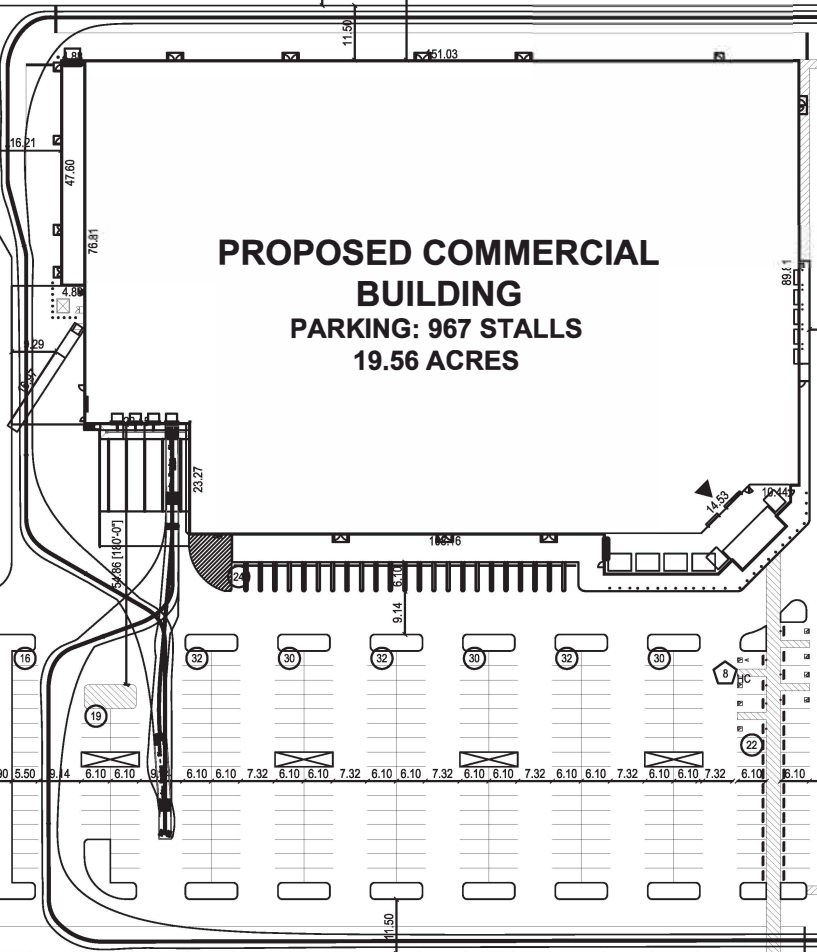

**PROPOSED COMMERCIAL
BUILDING
PARKING: 967 STALLS
19.56 ACRES**

ACCESS ROAD
(0.26 ACRES)

CATHERINE STREET

