

Guidelines for Tree Planting on the Right of Way

11 Size & Condition :

- 1) The minimum acceptable size is 45mm caliper (measured at 30cm above ground) for street trees.
- 2) Trees must be free of insects, diseases and any trunk/ branch breakage or scars.
- 3) Trees must have a strong fibrous root system sufficient to support tree life.

11.1. Location:

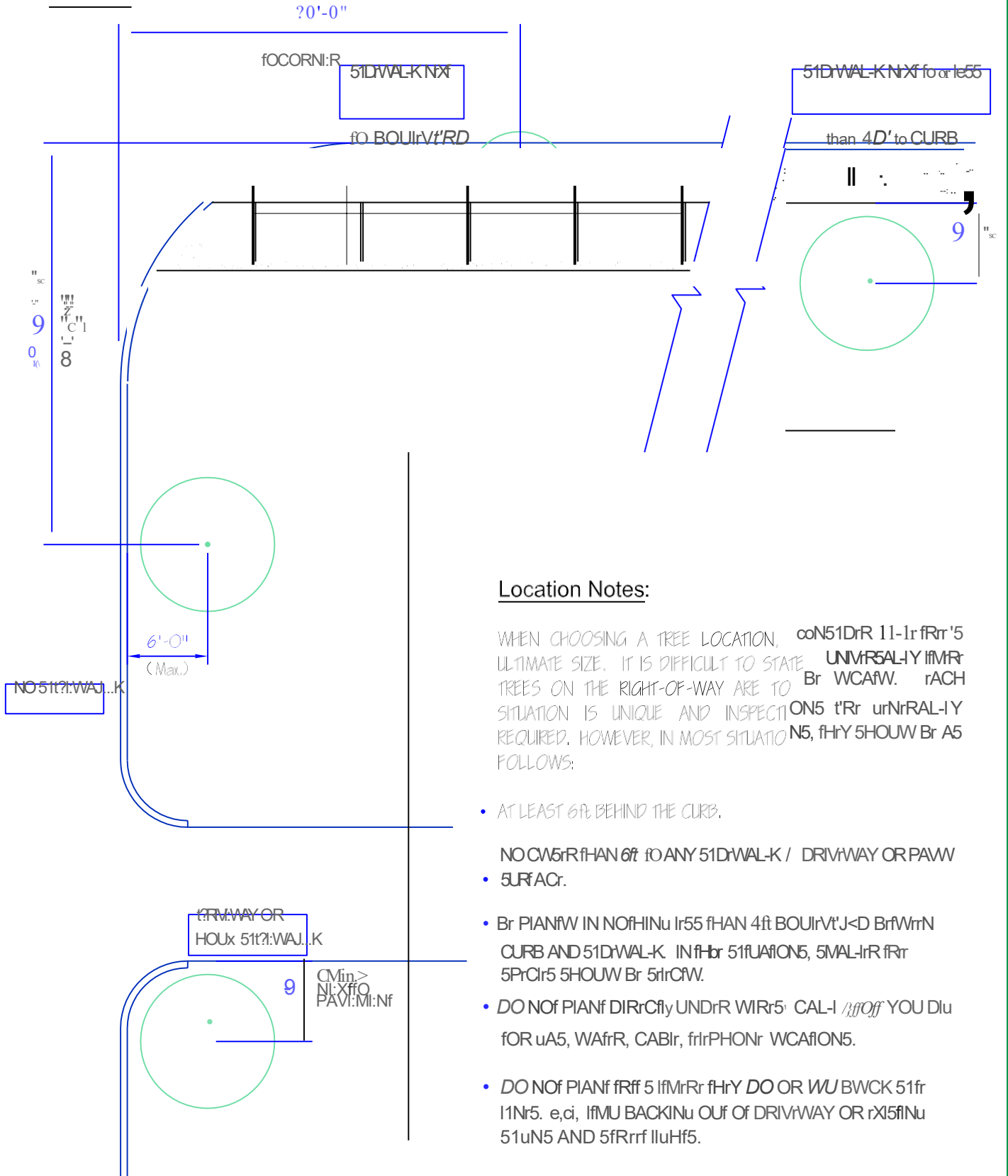

Location Notes:

WHEN CHOOSING A TREE LOCATION, coN51DrR 11-lr fRr'5 ULTIMATE SIZE, IT IS DIFFICULT TO STATE UNVR5AL-IY IfMFR Br WCAFW. rACH TREES ON THE RIGHT-OF-WAY ARE TO SITUATION IS UNIQUE AND INSPECTI ON5 t'Rr urNrRAL-IY REQUIRED. HOWEVER, IN MOST SITUATIO N5, fHrY 5HOUW Br A5 FOLLOWS:

- AT LEAST 6ft BEHIND THE CURB.
- NO CWA5r fHAN 6ft fO ANY 51D WAL-K / DRIVEWAY OR PAWW SURFACr.
- Br PIANfW IN NO fHINu lr55 fHAN 4ft BOUirVt'J<D Br fWrN CURB AND 51D WAL-K IN fHr 51fUAfION5, 5MAL-lr fRr 5PrCr5 5HOUW Br 5lrCfW.
- DO NOf PIANf DIRrCfY UNDrR WIRr5 CAL-I rffOff YOU DIu fOR uA5, WAFrR, CABlr, fHrPHONr WCAfION5.
- DO NOf PIANf fRff 5 IfMFRr fHrY DO OR WU BWCK 51fr 11Nr5. e.ci, IfMU BACKINu OUF Of DRIVEWAY OR rX15fINu 51uN5 AND 5fRrff lluHf5.

DRAWN BY: 5, P.H.
 APPROVED BY:
 DATE: M, CH 19, updated: July 2008
 BY: DEK

CITY OF WINDSOR PARKS & FACILITY OPERATIONS
 PROJECT: 5-txeet free Locations

SCALE: NottoScale
 SK-1

Guidelines for Tree Planting on the Right of Way

Recommended Tree Species

1. Only deciduous trees are recommended for street planting (see list below).
2. Where several trees are to be planted, no more than three (3) trees of one (1) species are to be planted consecutively.

Shade Trees

Common Name

Gleditsia triacanthos 'Inermis' & Var.	Honey Locust (light airy texture)
Platanus acerifolia	London Plane
Quercus alba	White Oak (dense shade, acorns)
Quercus rubra	Red Oak (dense shade, acorns)
Quercus macracarpa	Bur Oak (dense shade, acorns)
Cladrastis lutea	Yellowwood (white flower in June)
Liriodendron tulipifera	Tulip (interesting leaves)
Gymnocladus dioicus	Kentucky Coffee
Liquidambar styraciflua	Sweetgum (bright green leaves)
Celtis occidentalis	Hackberry
Tillia cordata	Linden

Ornamental Trees: (narrow boulevards or under wires)

Pyrus calleryana & Varieties	Bradford Pear (spring flowers)
Syringa reticulata	Japanese Lilac (white summer flower)
Corylus colurna	Turkish Hazel (hardy Pyramidal Tree)
Ginko Biloba	Maidenhair (use non fruit variety)
Acer platanoides columnar	Columnar Norway Maple (upright form)
Amelanchier arborea	Serviceberry or Juneberry (small)
Cornus florida	Flowering Dogwood (red berry, white flower)
Cercis canadensis	Eastern Redbud (excellent spring flower)