

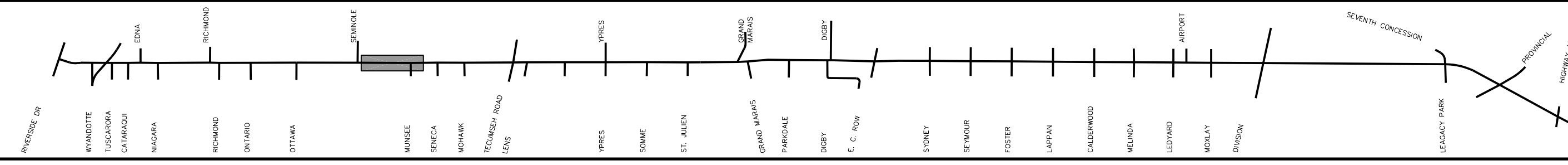

VIEW: SH18  
G:\CAD\996401\6401csm.dwg 03/22/2002 10:12:01 AM EST



- NEW SIDEWALKS
- NEW PAVEMENT
- EASEMENT
- PROPERTY ACQUISITION
- CONCEPTUAL DRIVEWAY LOCATION

LEGEND

- ROAD CLOSURE (DETAILS TO BE DETERMINED)
- EXISTING TRAFFIC SIGNAL
- NEW TRAFFIC SIGNAL

SCALE: 1500

MARCH, 2001

FIGURE 8

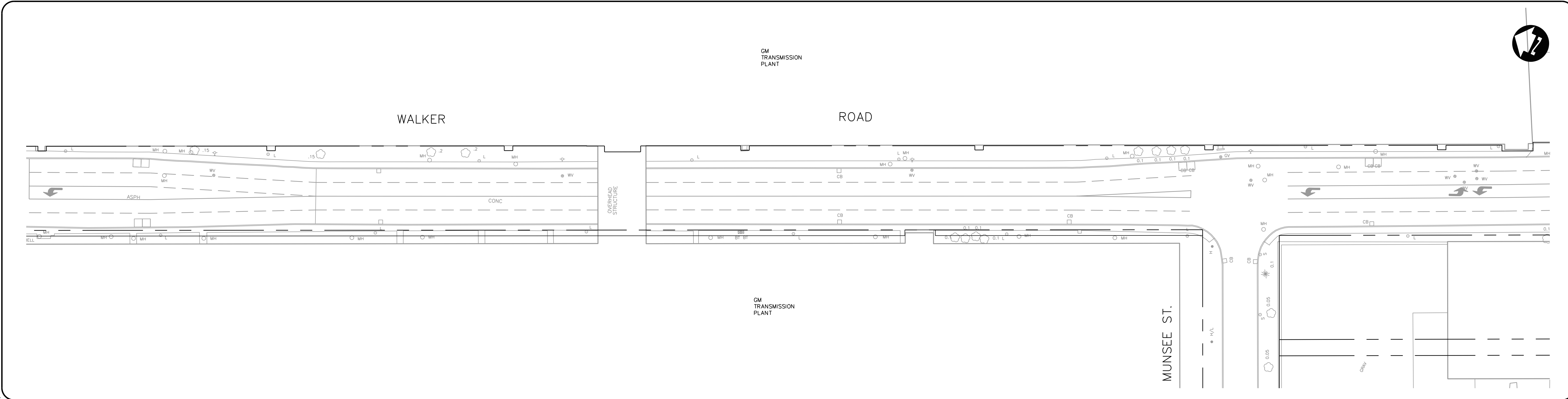

WALKER ROAD CORRIDOR  
GRAND MARAIS ROAD EAST IMPROVEMENTS  
ENVIRONMENTAL STUDY REPORT  
PREFERRED DESIGN

VIEW: SH9  
 G:\CAD\996401\k401ceem.dwg 03/22/2002 10:12:01 AM EST

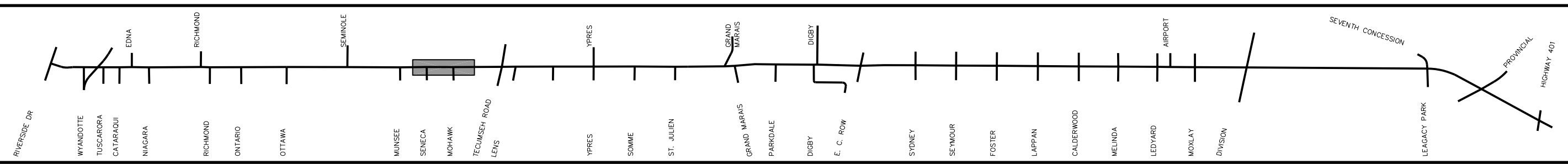
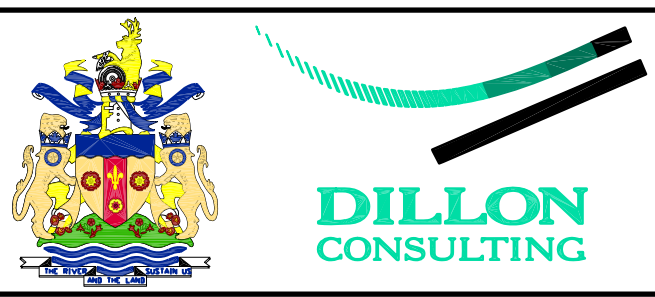
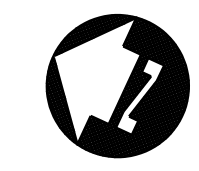
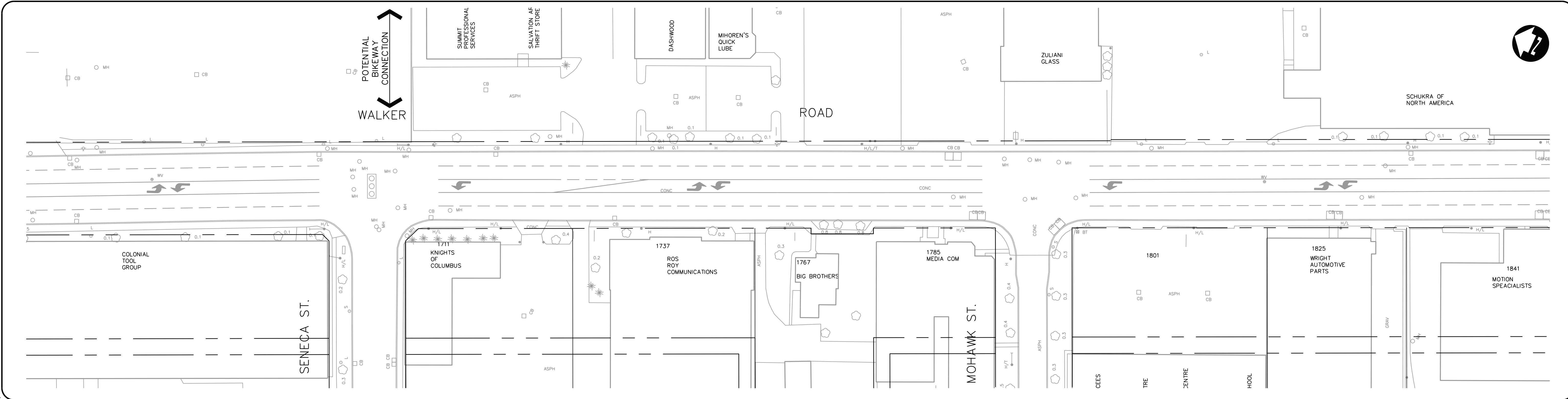

- NEW SIDEWALKS
- NEW PAVEMENT
- EASEMENT
- PROPERTY ACQUISITION
- CONCEPTUAL DRIVEWAY LOCATION

**LEGEND**

- ROAD CLOSURE  
(DETAILS TO BE DETERMINED)
- EXISTING TRAFFIC SIGNAL
- NEW TRAFFIC SIGNAL

SCALE: 1500

MARCH, 2001

FIGURE 9

**WALKER ROAD CORRIDOR  
 GRAND MARAIS ROAD EAST IMPROVEMENTS  
 ENVIRONMENTAL STUDY REPORT  
 PREFERRED DESIGN**