

VIEW: SH29  
 G:\CAD\996401\6401\_sen1.dwg 03/14/2002 08:06:56 AM EST

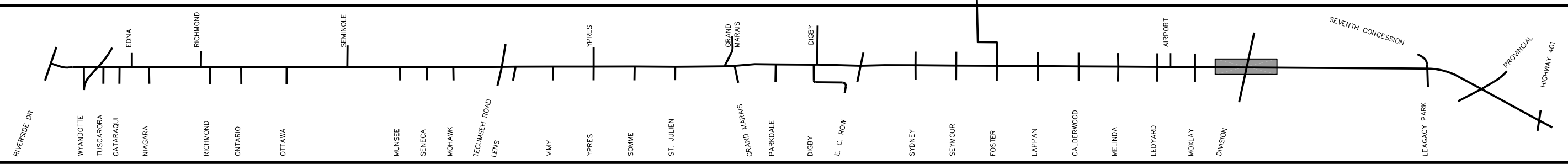
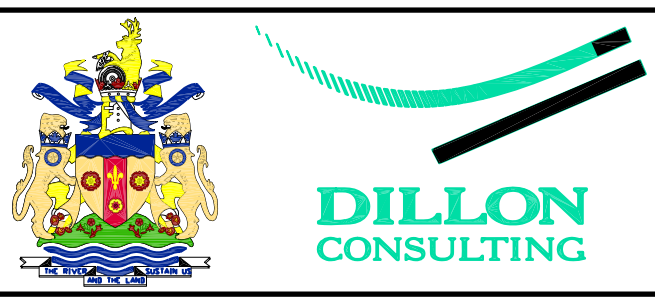

**LEGEND**

- NEW SIDEWALKS
- NEW PAVEMENT
- EASEMENT
- PROPERTY ACQUISITION
- CONCEPTUAL DRIVEWAY LOCATION
- ROAD CLOSURE (DETAILS TO BE DETERMINED)
- EXISTING TRAFFIC SIGNAL
- NEW TRAFFIC SIGNAL

**WALKER ROAD CORRIDOR  
 GRAND MARAIS ROAD EAST IMPROVEMENTS  
 ENVIRONMENTAL STUDY REPORT  
 PREFERRED DESIGN**

SCALE: 1500      MARCH, 2001      **FIGURE 29**

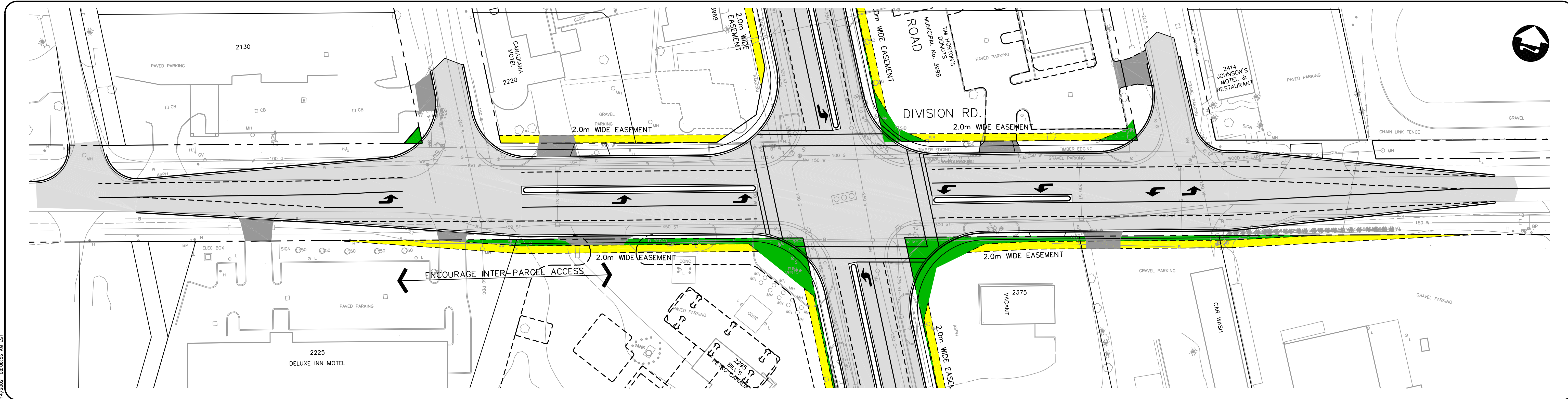

VIEW: SH130  
 G:\CAD\996401\6401\_sen1.dwg 03/14/2002 08:06:56 AM EST

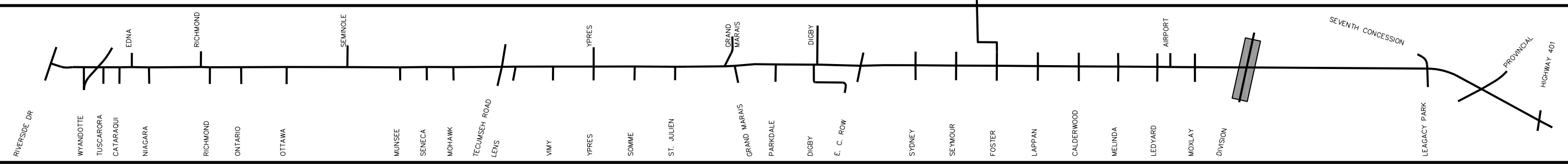
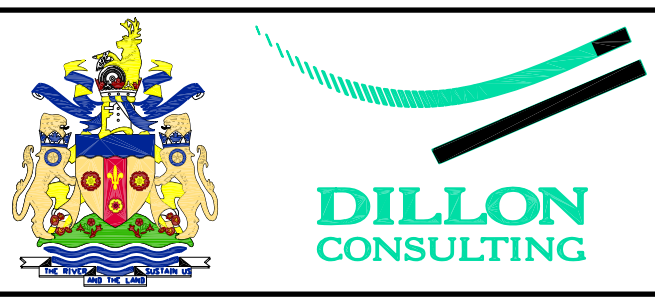

- NEW SIDEWALKS
- NEW PAVEMENT
- EASEMENT
- PROPERTY ACQUISITION
- CONCEPTUAL DRIVEWAY LOCATION

**LEGEND**

- ROAD CLOSURE  
(DETAILS TO BE DETERMINED)
- EXISTING TRAFFIC SIGNAL
- NEW TRAFFIC SIGNAL

SCALE: 1500

MARCH, 2001

FIGURE 30

**WALKER ROAD CORRIDOR  
 GRAND MARAIS ROAD EAST IMPROVEMENTS  
 ENVIRONMENTAL STUDY REPORT  
 PREFERRED DESIGN**

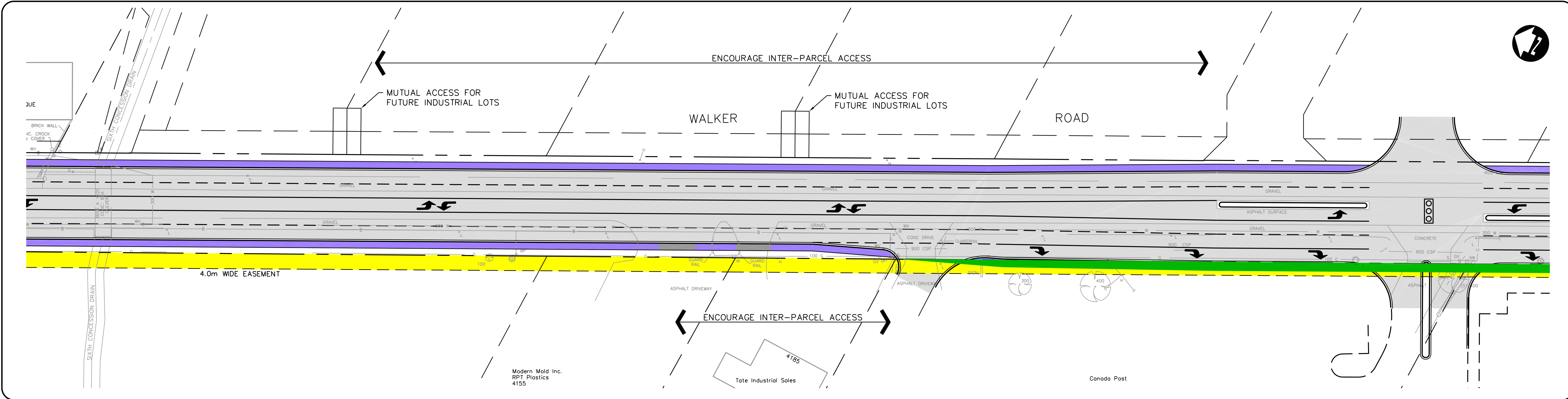

VIEW: SH31  
 G:\CAD\996401\k401stn.dwg 03/27/01 02:08:16 PM EST

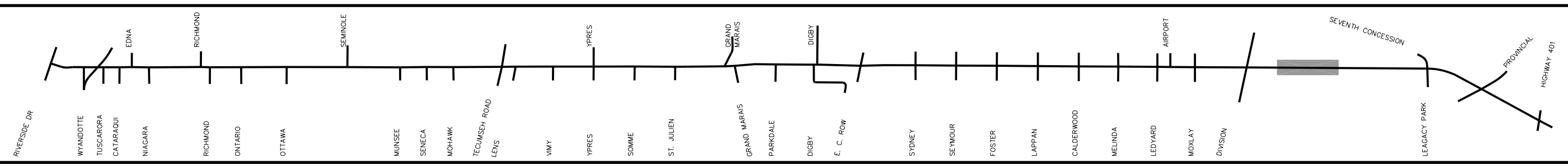
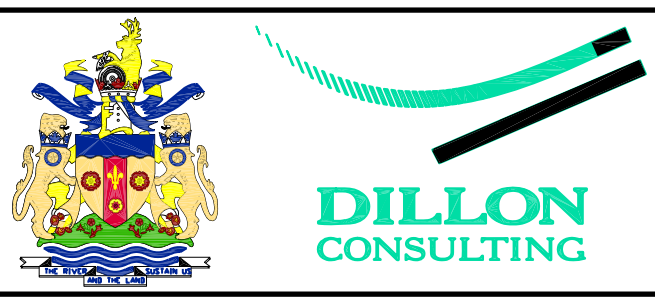

- NEW SIDEWALKS
- NEW PAVEMENT
- EASEMENT
- PROPERTY ACQUISITION
- CONCEPTUAL DRIVEWAY LOCATION

**LEGEND**

- ROAD CLOSURE (DETAILS TO BE DETERMINED)
- EXISTING TRAFFIC SIGNAL
- NEW TRAFFIC SIGNAL

SCALE: 1500

MARCH, 2001

FIGURE 31

**WALKER ROAD CORRIDOR  
 GRAND MARAIS ROAD EAST IMPROVEMENTS  
 ENVIRONMENTAL STUDY REPORT  
 PREFERRED DESIGN**