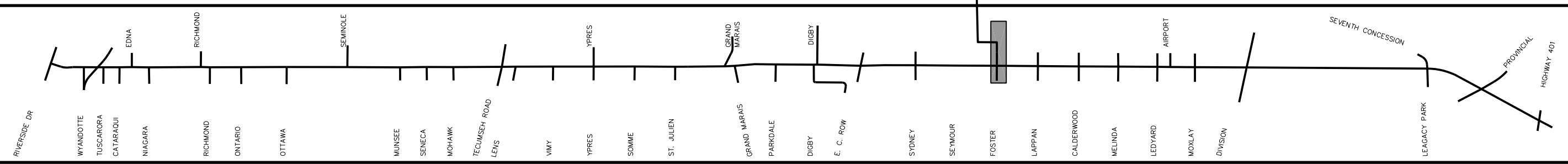
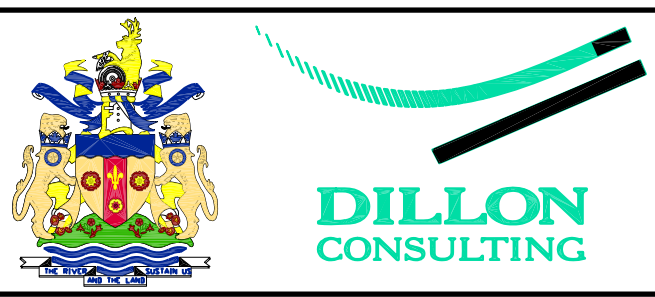
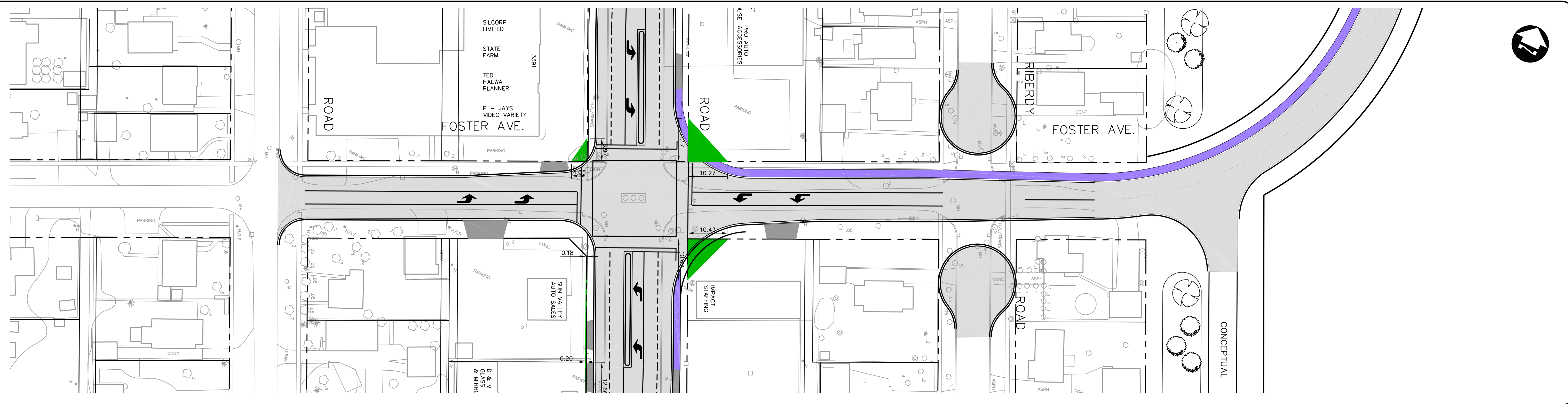


VIEW: SH22
 G:\CAD\996401\6401_s-cent.dwg 03/17/2002 08:06:56 AM EST



- NEW SIDEWALKS
- NEW PAVEMENT
- EASEMENT
- PROPERTY ACQUISITION
- CONCEPTUAL DRIVEWAY LOCATION

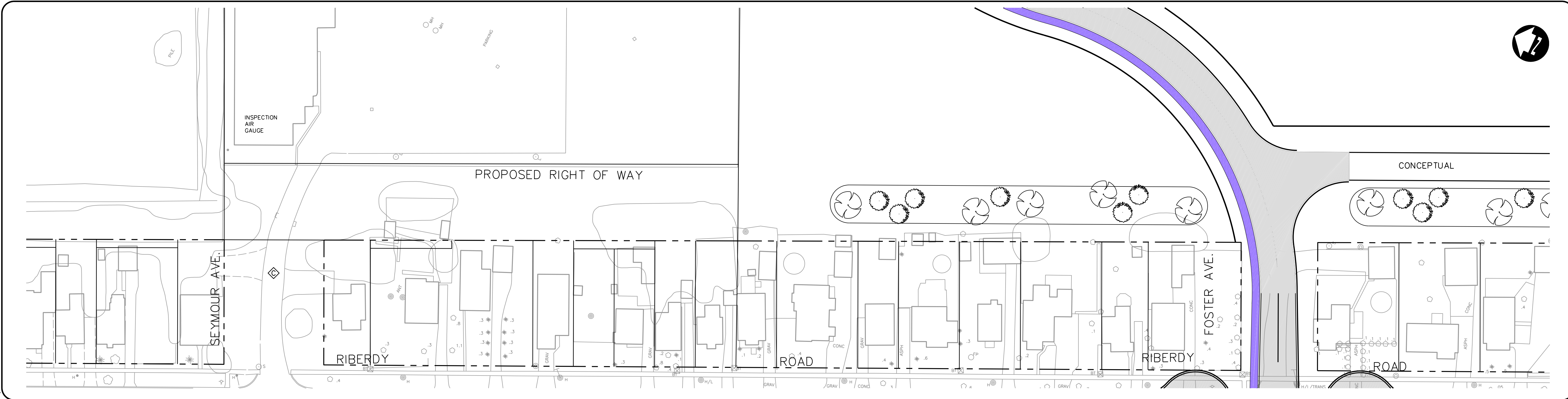
- LEGEND**
- ROAD CLOSURE (DETAILS TO BE DETERMINED)
 - EXISTING TRAFFIC SIGNAL
 - NEW TRAFFIC SIGNAL

SCALE: 1:500

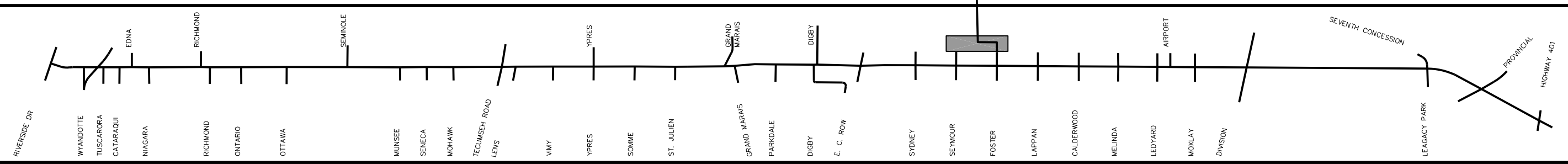
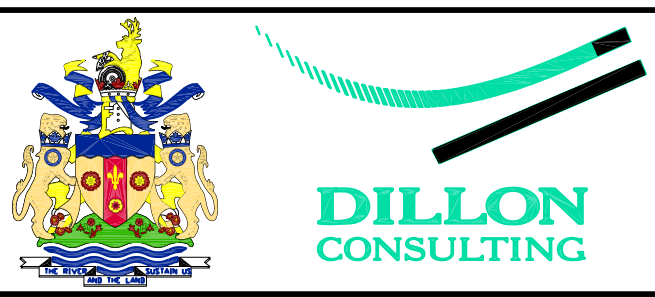
MARCH, 2001




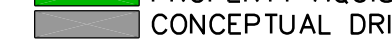

FIGURE 22

**WALKER ROAD CORRIDOR
 GRAND MARAIS ROAD EAST IMPROVEMENTS
 ENVIRONMENTAL STUDY REPORT
 PREFERRED DESIGN**






VIEW: SH23_CP-A
 G:\CAD\996401\6401_sen1.dwg 03/17/2002 08:06:56 AM EST



-  NEW SIDEWALKS
-  NEW PAVEMENT
-  EASEMENT
-  PROPERTY ACQUISITION
-  CONCEPTUAL DRIVEWAY LOCATION

LEGEND

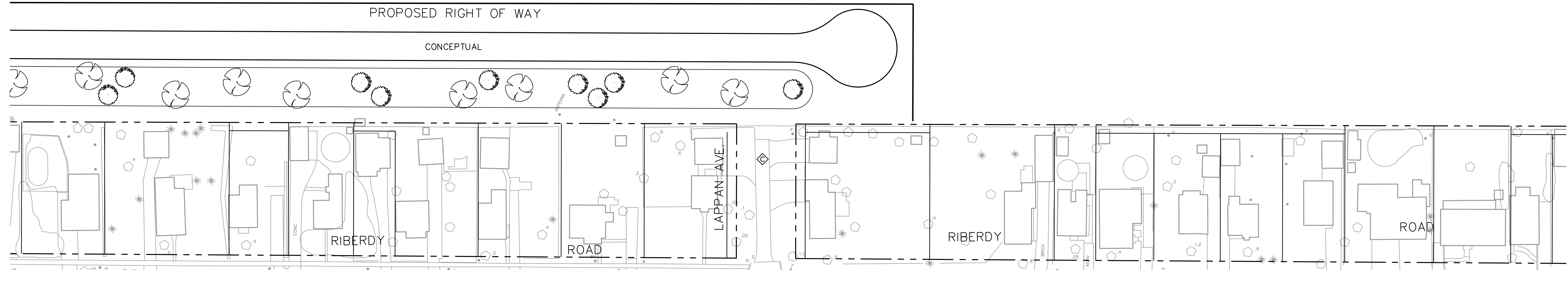
-  ROAD CLOSURE (DETAILS TO BE DETERMINED)
-  EXISTING TRAFFIC SIGNAL
-  NEW TRAFFIC SIGNAL

SCALE: 1500

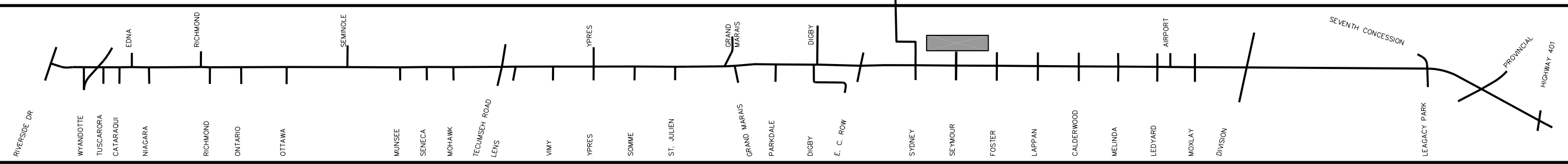
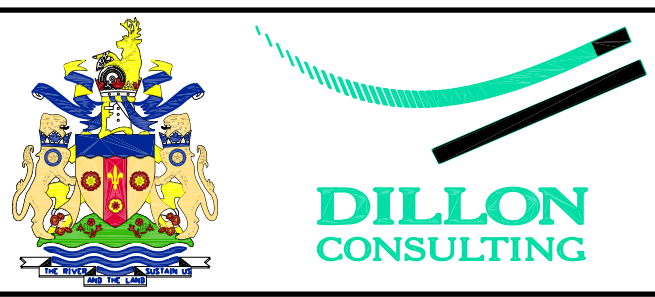
MARCH, 2001

FIGURE 23

**WALKER ROAD CORRIDOR IMPROVEMENTS
 GRAND MARAIS ROAD EAST IMPROVEMENTS
 ENVIRONMENTAL STUDY REPORT
 PREFERRED DESIGN**






VIEW: SH24
 G:\CAD\996401\6401s_cent.dwg 03/17/2002 08:06:56 AM EST



- NEW SIDEWALKS
- NEW PAVEMENT
- EASEMENT
- PROPERTY ACQUISITION
- CONCEPTUAL DRIVEWAY LOCATION

LEGEND

-  ROAD CLOSURE (DETAILS TO BE DETERMINED)
-  EXISTING TRAFFIC SIGNAL
-  NEW TRAFFIC SIGNAL

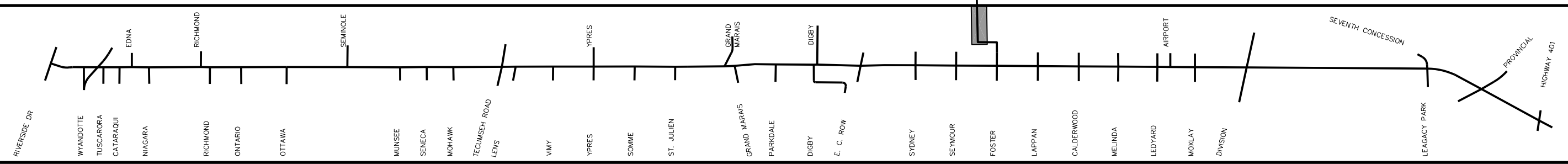
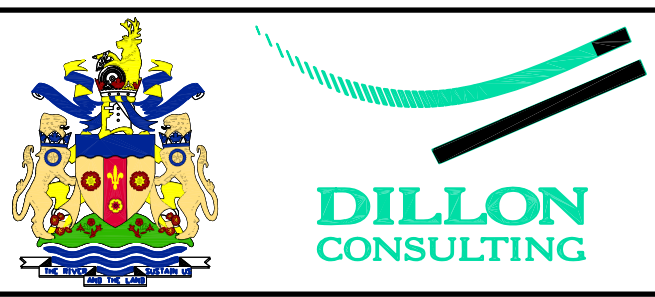
SCALE: 1500

MARCH, 2001

FIGURE 24

**WALKER ROAD CORRIDOR
 GRAND MARAIS ROAD EAST IMPROVEMENTS
 ENVIRONMENTAL STUDY REPORT
 PREFERRED DESIGN**

VIEW: SH25
 G:\CAD\996401\6401_scent.dwg 03/14/2002 08:06:56 AM EST



- NEW SIDEWALKS
- NEW PAVEMENT
- EASEMENT
- PROPERTY ACQUISITION
- CONCEPTUAL DRIVEWAY LOCATION

LEGEND

- ROAD CLOSURE
(DETAILS TO BE DETERMINED)
- EXISTING TRAFFIC SIGNAL
- NEW TRAFFIC SIGNAL

SCALE: 1500

MARCH, 2001

FIGURE 25

