

VIEW: SH10
 G:\CAD\996401\k401ccen.dwg 03/22/2002 10:12:01 AM EST

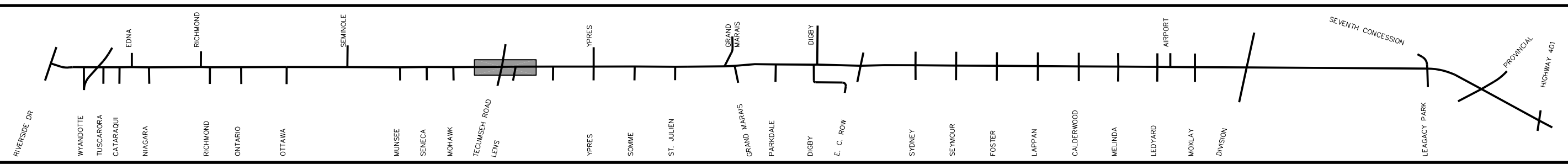
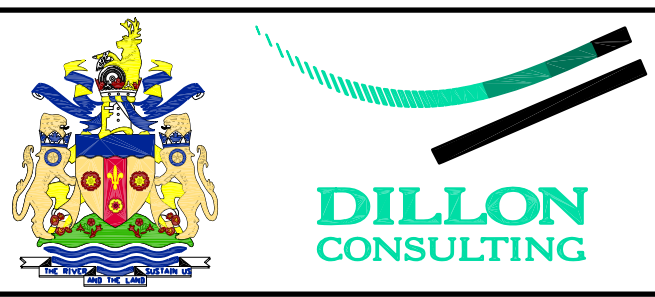

- NEW SIDEWALKS
- NEW PAVEMENT
- EASEMENT
- PROPERTY ACQUISITION
- CONCEPTUAL DRIVEWAY LOCATION

LEGEND

- ROAD CLOSURE
(DETAILS TO BE DETERMINED)
- EXISTING TRAFFIC SIGNAL
- NEW TRAFFIC SIGNAL

SCALE: 1500

MARCH, 2001

FIGURE 10

**WALKER ROAD CORRIDOR
 GRAND MARAIS ROAD EAST IMPROVEMENTS
 ENVIRONMENTAL STUDY REPORT
 PREFERRED DESIGN**

VIEW: SH11
G:\CAD\996401\k401cen.dwg 03/22/2002 10:12:01 AM EST

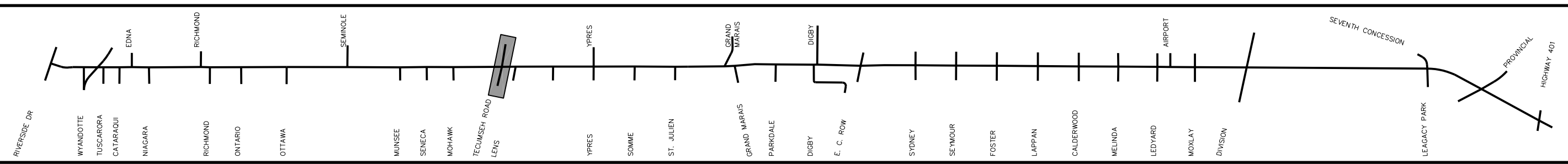
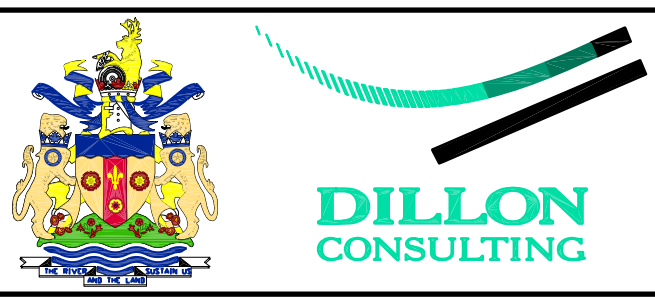
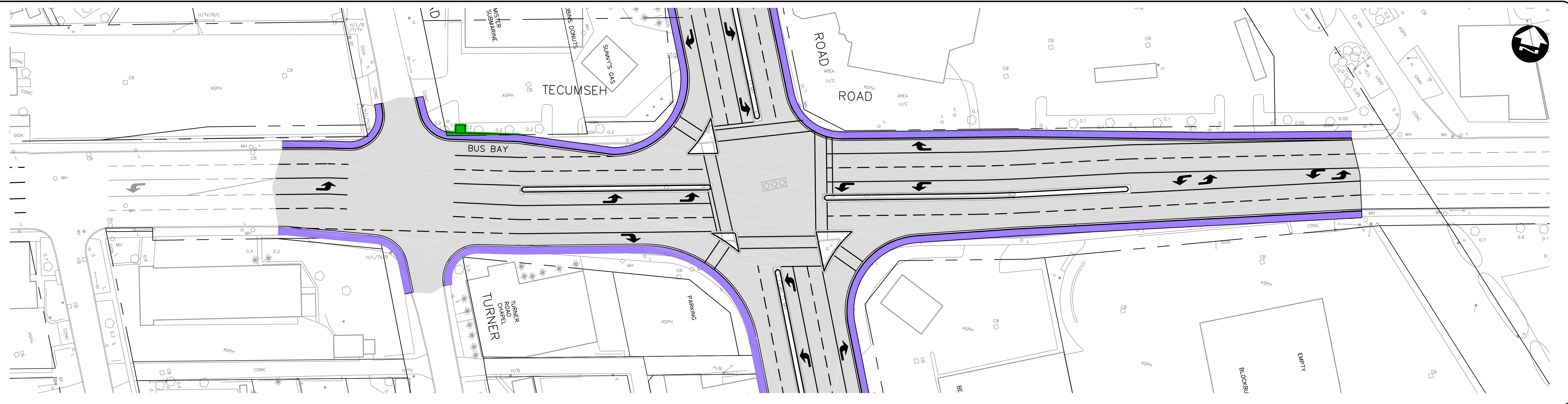

- NEW SIDEWALKS
- NEW PAVEMENT
- EASEMENT
- PROPERTY ACQUISITION
- CONCEPTUAL DRIVEWAY LOCATION

LEGEND

- ROAD CLOSURE (DETAILS TO BE DETERMINED)
- EXISTING TRAFFIC SIGNAL
- NEW TRAFFIC SIGNAL

SCALE: 1:500

MARCH, 2001

FIGURE 11

**WALKER ROAD CORRIDOR
 GRAND MARAIS ROAD EAST IMPROVEMENTS
 ENVIRONMENTAL STUDY REPORT
 PREFERRED DESIGN**

VIEW: SH12
G:\CAD\996401\k401cen.dwg 03/22/2002 10:17:01 AM EST

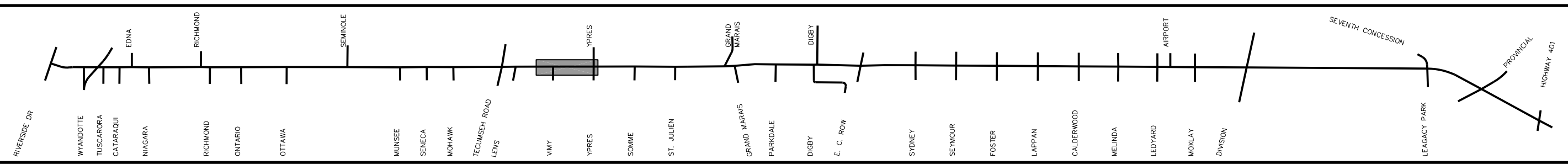
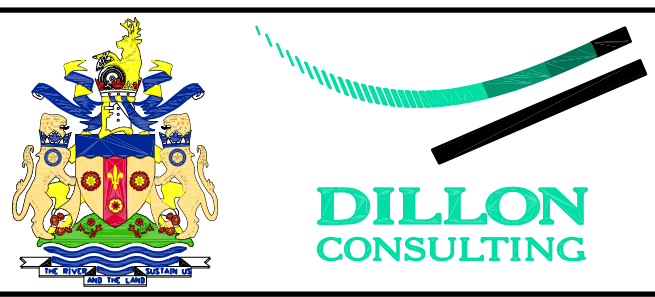
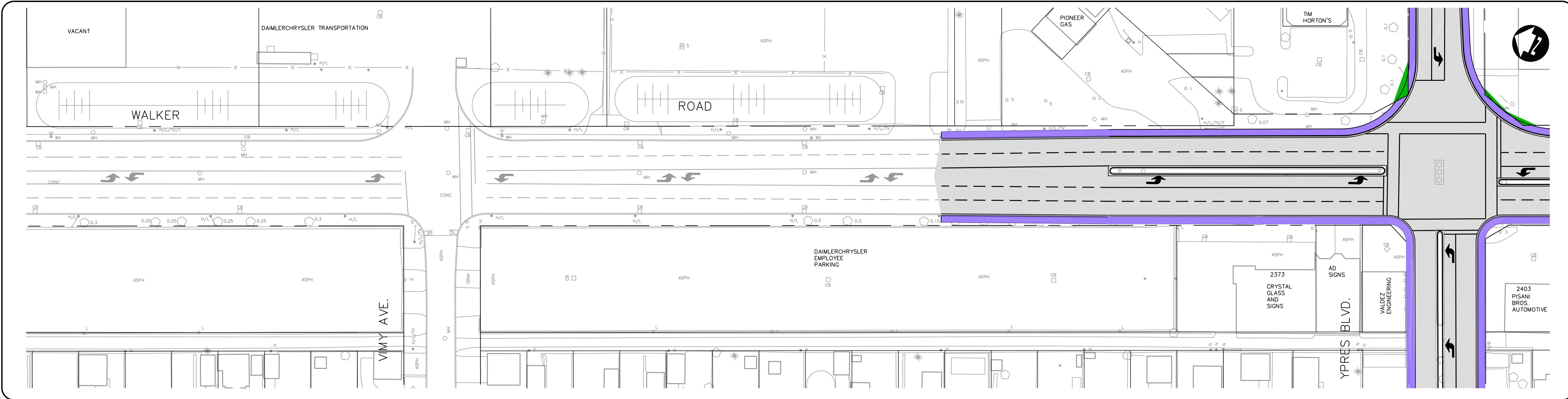

- NEW SIDEWALKS
- NEW PAVEMENT
- EASEMENT
- PROPERTY ACQUISITION
- CONCEPTUAL DRIVEWAY LOCATION

LEGEND

- ROAD CLOSURE (DETAILS TO BE DETERMINED)
- EXISTING TRAFFIC SIGNAL
- NEW TRAFFIC SIGNAL

SCALE: 1:500

MARCH, 2001

FIGURE 12

**WALKER ROAD CORRIDOR
GRAND MARAIS ROAD EAST IMPROVEMENTS
ENVIRONMENTAL STUDY REPORT
PREFERRED DESIGN**