

VIEW: SH1
G:\CAD\996401\6401rdr.dwg 26/07/01 12:29:57 PM EDT

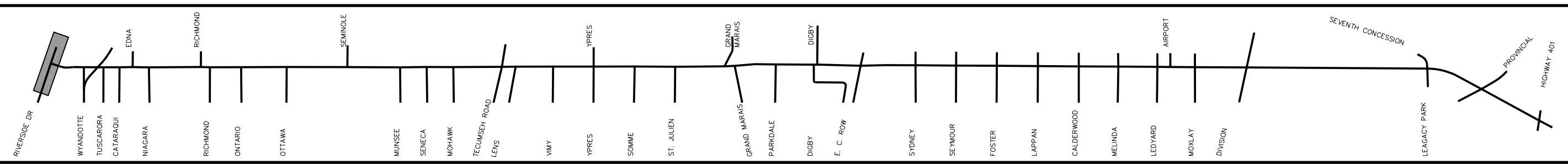
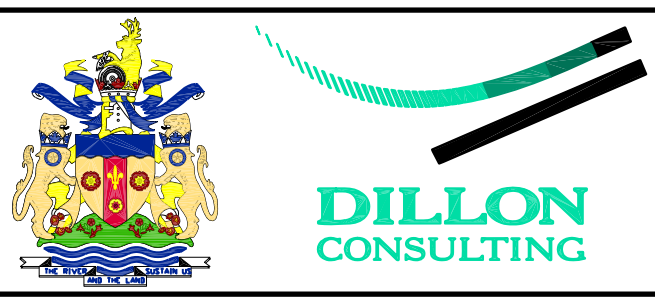
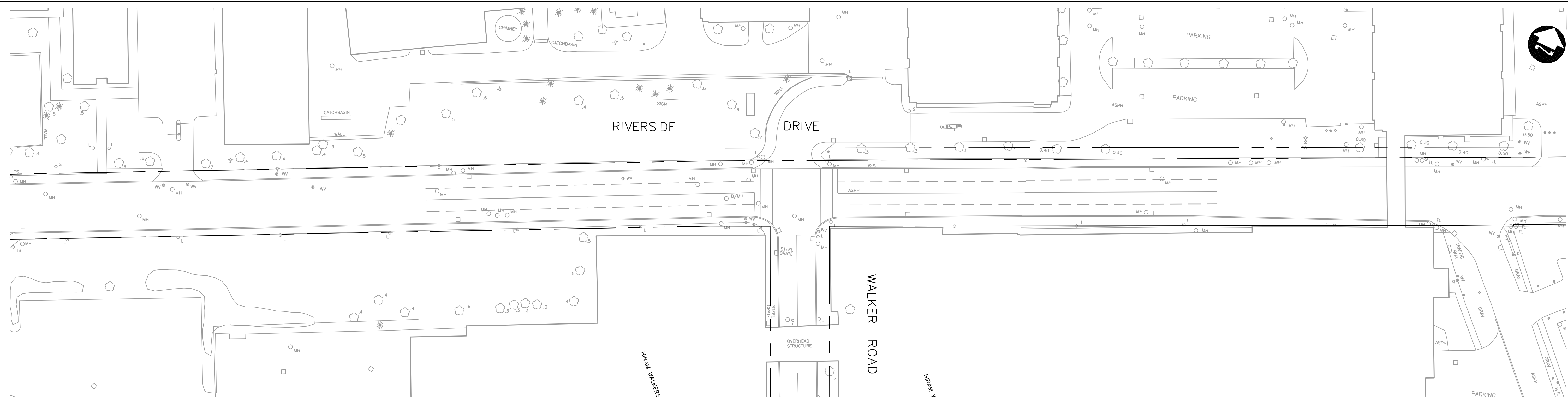

- NEW SIDEWALKS
- NEW PAVEMENT
- EASEMENT
- PROPERTY ACQUISITION
- CONCEPTUAL DRIVEWAY LOCATION

LEGEND

- ROAD CLOSURE (DETAILS TO BE DETERMINED)
- EXISTING TRAFFIC SIGNAL
- NEW TRAFFIC SIGNAL

SCALE: 1500

MARCH, 2001

FIGURE 1

**WALKER ROAD CORRIDOR
GRAND MARAIS ROAD EAST IMPROVEMENTS
ENVIRONMENTAL STUDY REPORT
PREFERRED DESIGN**

VIEW: SH2
G:\CAD\996401\6401rdr.dwg 26/07/01 12:29:57 PM EDT

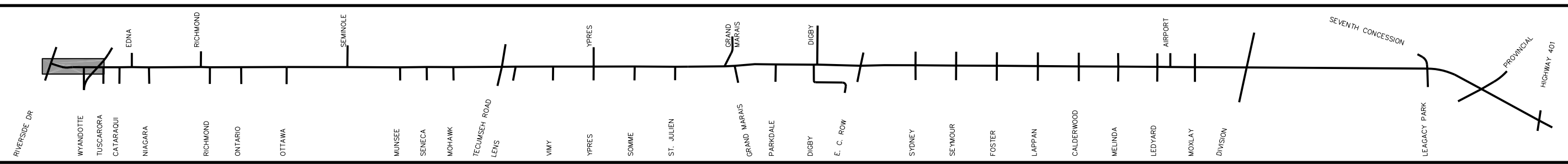
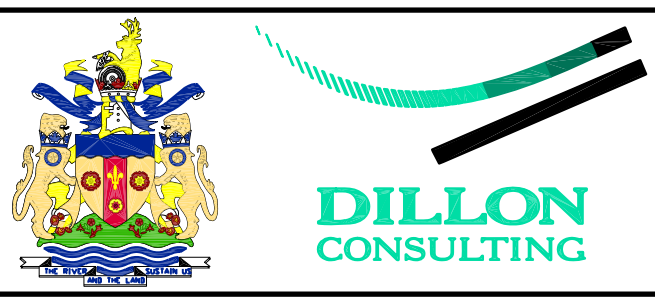
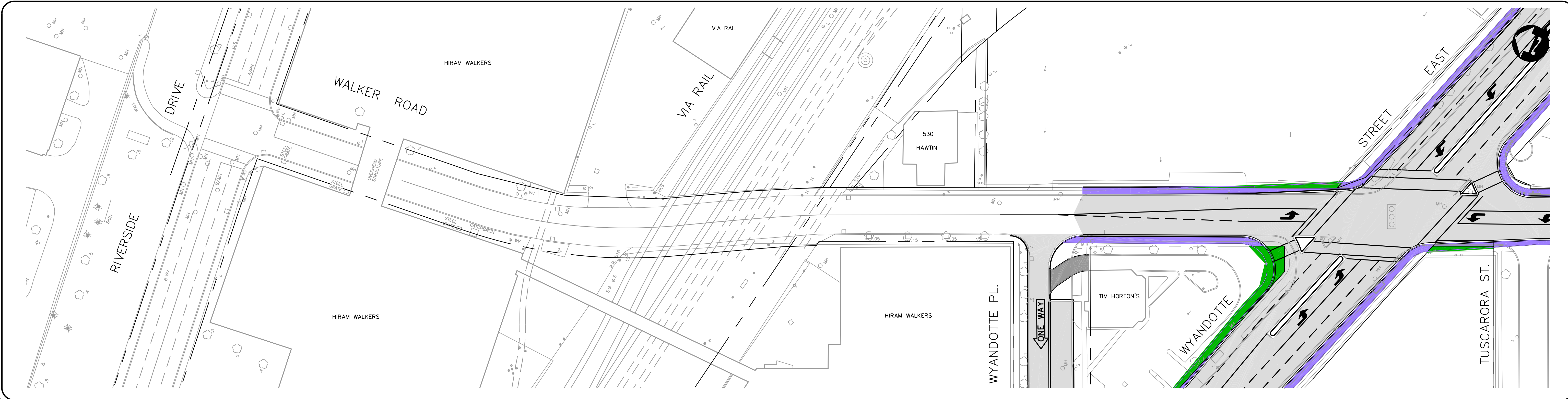

- NEW SIDEWALKS
- NEW PAVEMENT
- EASEMENT
- PROPERTY ACQUISITION
- CONCEPTUAL DRIVEWAY LOCATION

LEGEND

- ROAD CLOSURE (DETAILS TO BE DETERMINED)
- EXISTING TRAFFIC SIGNAL
- NEW TRAFFIC SIGNAL

SCALE: 1500

MARCH, 2001

FIGURE 2

**WALKER ROAD CORRIDOR
GRAND MARAIS ROAD EAST IMPROVEMENTS
ENVIRONMENTAL STUDY REPORT
PREFERRED DESIGN**

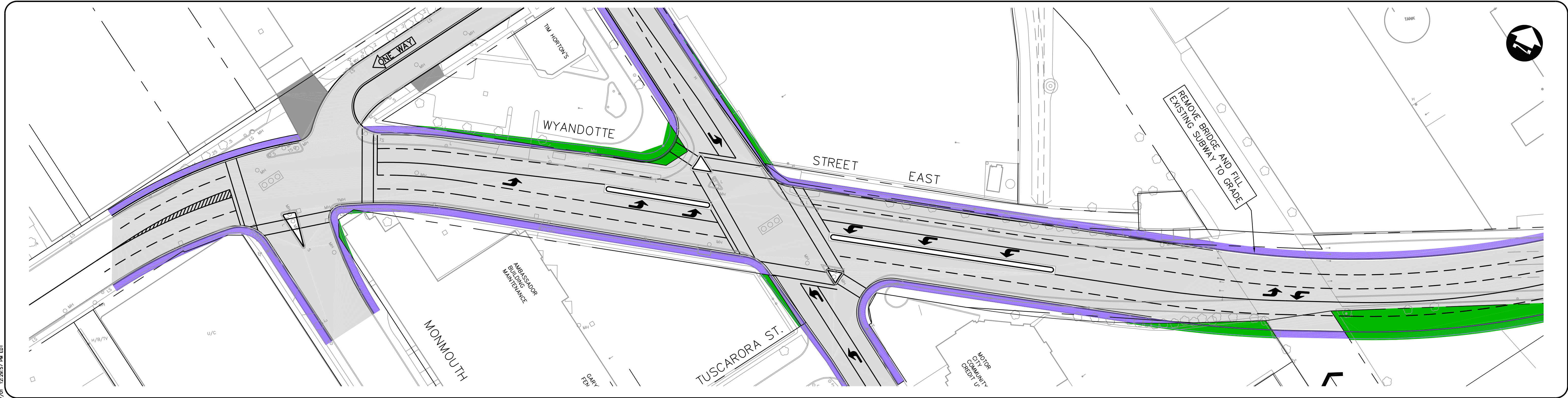

VIEW: SH13
 G:\CAD\996401\6401rdrn.dwg 26/07/01 12:29:57 PM EDT

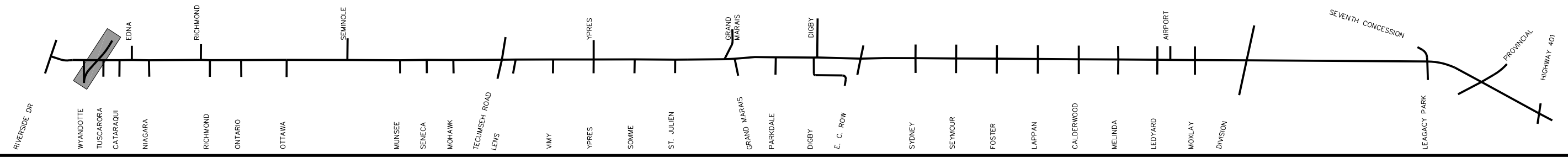

- NEW SIDEWALKS
- NEW PAVEMENT
- EASEMENT
- PROPERTY ACQUISITION
- CONCEPTUAL DRIVEWAY LOCATION

LEGEND

- ROAD CLOSURE (DETAILS TO BE DETERMINED)
- EXISTING TRAFFIC SIGNAL
- NEW TRAFFIC SIGNAL

SCALE: 1500

MARCH, 2001

FIGURE 3

**WALKER ROAD CORRIDOR
 GRAND MARAIS ROAD EAST IMPROVEMENTS
 ENVIRONMENTAL STUDY REPORT
 PREFERRED DESIGN**