

Adopted by Council at its meeting held July 23, 2012
as presented, on the condition that City of Windsor display
tags are provided to the Greater Essex County District
School Board for those using the Church Street parking
lots, which would be enforced by the Commissionaires,
with the Board being responsible for any towing required.

[M317-2012]

/AA

Windsor, Ontario July 23 2012

REPORT NO. 67 of the
ENVIRONMENT & TRANSPORTATION STANDING COMMITTEE
of its meeting held June 27, 2012

Present: **Councillor Hatfield, Chair**
 Councillor Halberstadt
 Councillor Payne
 Councillor Sleiman

Regrets: **Councillor Valentinis**

That the following recommendations of the Environment and Transportation
Standing Committee **BE APPROVED:**

Moved by Councillor Sleiman, seconded by Councillor Halberstadt,

THAT CR1377/95 **BE WAIVED** and that the Parking By-law 9023 **BE AMENDED** as listed and attached in Appendix "A" of this report to reflect that residential permit parking will be in effect for Dougall Avenue from Park Street West to Wyandotte Street West and for Church Street from Park Street West to Wyandotte Street West and further, that the City Solicitor prepare the necessary documents to amend the by-law, and further
Carried.

Clerk's Note: The report authored by the City Engineer dated June 13, 2012 entitled "Residential Permit Parking Petition for Dougall Avenue and Church Street" is attached as background information.

Livelihood 15937, ST2012

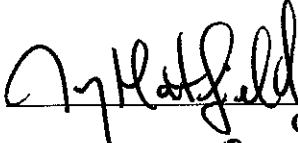

CHAIRPERSON

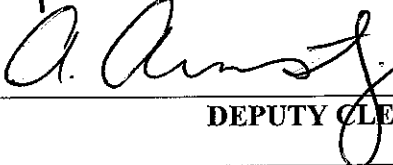

DEPUTY CLERK

NOTIFICATION:

Name	Address	Email Address	Telephone	FAX
------	---------	---------------	-----------	-----

Al Frederick, Acting Chief of Police		afrederick@police.windsor.on.ca		
V. Lipnicki		vlipnicki@city.windsor.on.ca		
B. Kralovensky		bkralovensky@city.windsor.on.ca		
M. Palanacki		mpalanacki@city.windsor.on.ca		
J. Wolf		jwolf@city.windsor.on.ca		
Geo. Wilkki		gwilkki@city.windsor.on.ca		
Penny Allen	GECDSB, 451 Park St. West Windsor, ON N9A 5V4			
Mario Iatonna	WECDSB 1325 California Av Windsor ON N9B 3Y6			



AMENDMENTS TO PARKING BY LAW 9023
APPENDIX "A"

M317-2012
July 23, 2012

ITEM	REGULATION	STREET	DESCRIPTION AND LOCATION					REASON	
			Area	Street and Portions of Street	Parking Limit - Time and Day	During the months	During the months	Number of Permits per household	
1	Schedule "GG" Relating to On street Parking Areas ADD	Church Street	12	Church Street from Park Street to Wyandotte Street West	24 hours Monday through Sunday	West Side	East Side	At Executive Director of Operations discretion	Successful Petition
2	Schedule "GG" Relating to On street Parking Areas ADD	Dougall Avenue	12	Dougall Avenue from Park Street to Wyandotte Street West	24 hours - Monday through Sunday	West side	At Executive Director of Operations discretion	At Executive Director of Operations discretion	Successful Petition



THE CORPORATION OF THE CITY OF WINDSOR
Engineering & Transportation Standing Committee – Administrative Report



MISSION STATEMENT:

"The City of Windsor, with the involvement of its citizens, will deliver effective and responsive municipal services, and will mobilize innovative community partnerships"

LiveLink REPORT # 15937 ST2012	Report Date: June 13, 2012 (3340pg-6/14/12:ebr)
Author's Name: Josette Eugeni	Date to Standing Committee: June 27, 2012
Author's Phone: (519) 255-6418	
Author's Email: jeugeni@city.windsor.on.ca	

TO: Environment & Transportation Standing Committee

SUBJECT: Residential Permit Parking Petition for Dougall Avenue and Church Street

1. RECOMMENDATION: City Wide: ___ Ward(s)3

That the Parking By law 9023 be amended as listed and attached in Appendix "A" of this report to reflect that residential permit parking will be in effect for Dougall Avenue from Park Street West to Wyandotte Street West and for Church Street from Park Street West to Wyandotte Street West and further, that the City Solicitor prepare the necessary documents to amend the by law.

2. BACKGROUND:

The amendments listed in Appendix "A" of this report are as a result of a sufficiently signed petition.

3. DISCUSSION:

Residential Permit Parking – Church Street and Dougall Avenue (items 1 and 2)

As illustrated in the attached petition letter, sketch and petition that was submitted for Permit Parking Dougall Avenue and Church Street (see Appendix "B" and Drawing No. C-3152).

On December 18, 1995, Council considered a report regarding residential permit parking. As a result, Council Resolution CR 1377/95 was adopted.

CR1377/95

That the existing permit parking policy approved by Council Resolution 1442/94 on December 12, 1994 BE AMENDED as follows:

- Permit parking be restricted to areas adjacent to the University of Windsor and the Central Business District, as determined by the Commissioner of Traffic Engineering;
- Annual permit fees be \$30.00 for the first, \$15.00 for the second and \$30.00 for additional or replacement permits, (as amended by

bylaw 47-2012 April 16, 2012). It should be noted that as per CR585/96 for new permit parking areas: \$50.00 for the first permit, \$20.00 for the second and \$50.00 for additional or replacement permits **for the first year only**, with renewals as noted above.

- New areas to be considered for permit parking will be required to demonstrate a 95% community approval rating for permit parking.

The current petition area is partially within the Central Business District and is a portion of former Area 12 Residential on street permit parking area. On this basis this area is considered in compliance with CR1377/95 provided 95% community approval rating is demonstrated. Residential permit Area 12(refer to the attached diagram Appendix "C") was deleted in its entirety (By-Law Number 184-1999) on June 28, 1999. Subsequently two unsuccessful petitions were circulated within the original Permit Parking Area 12 to reinstate residential permit parking. The results are as follows:

- Petition circulated for all of residential permit parking Area 12 in 1998 receiving 13 % support
- Petition circulated for this same portion of residential permit parking Area 12 currently petitioned (Dougall Avenue and Church Street from Park Street West to Wyandotte Street West) in 2006 receiving 37% support.

A petition was prepared by Administration and recently circulated by a resident to amend the current by-law to include "Residential Permit Parking" on Dougall Avenue and Church Street from Park Street West to Wyandotte Street West.

The current study area encompasses 81 properties. 6 Properties were identified as neutral for the following reasons reducing the petition area to 75 properties:

- 2 properties are vacant land(one is City owned)
- 4 properties were unoccupied/owner unreachable

Of the 75 petition area properties 71 or (95%) support the circulated petition. 4 (5%) of the affected properties were identified as opposed to the parking amendment; the Greater Essex County District School Board representing 3 properties among those opposed.

This report is brought to Committee and City Council as a portion of the permit parking area was outside the limits identified in CR1377/95. It is necessary to insure that an opportunity for discussion was made available.

Should approval be granted, notification letters containing instructions will be distributed to the affected properties.

4. FINANCIAL MATTERS:

N/A

5. CONSULTATIONS:

- G. Wilkki, City Solicitor and Corporate Leader Economic Development and Public Safety
- A. Frederick, Chief of Police
- M. Sonogo, City Engineer and Corporate Leader Environmental Protection and Transportation
- M. Palanacki, Executive Director of Operations
- W. Hicks, Senior Manager, Infrastructure and Transportation Planning/Deputy City Engineer
- B. Murray, Executive Administrative Assistant – Council Services
- B. Kralovensky, Supervisor of Parking Enforcement
- Councillor Valentinis

6. CONCLUSION:

Proposals in Appendix "A" are consistent with existing by law regulations.



Josette Eugeni
Manager of Transportation Planning

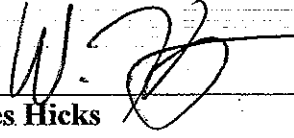

Wes Hicks
Senior Manager, Infrastructure and Transportation Planning/Deputy City Engineer

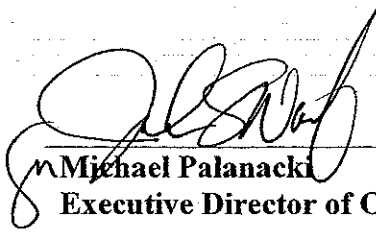

Michael Palanacki
Executive Director of Operations

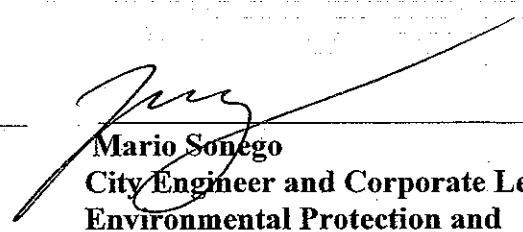

Mario Sonogo
City Engineer and Corporate Leader Environmental Protection and Transportation

SG/pg

APPENDICES:

APPENDIX "A" - TABLE OF AMENDMENTS TO PARKING BY LAW 9023

APPENDIX "B" - PETITION INCLUDING LETTER AND SKETCH FOR PERMIT PARKING DOUGALL AVENUE AND CHURCH STREET

APPENDIX "C" - FORMER AREA 12 RESIDENTIAL ON-STREET PERMIT PARKING AREA

DEPARTMENTS/OTHERS CONSULTED:

Name:

Phone #: 519 ext.

NOTIFICATION :

Name	Address	Email Address	Telephone	FAX
G. WILKKI, CITY SOLICITOR				
A. FREDERICK, CHIEF OF POLICE				
COURT ADMINISTRATOR				
SUPERVISOR OF PARKING ENFORCEMENT				
EXECUTIVE DIRECTOR OF OPERATIONS				
MANAGER OF TRAFFIC OPERATIONS				
PENNY ALLEN, GREATER ESSEX COUNTY DISTRICT SCHOOL BOARD				
SEE ATTACHED LIST				

Name	Address	Postal Code	Telephone	Fax
	317 Park Street	N/A		
	455 Dougall Avenue	N9A 4P7		
	477 Dougall Avenue Unit 1	N9A 4P7		
	477 Dougall Ave Unit 2	N9A 4P7		
	477 Dougall Avenue Unit 3	N9A 4P7		
	477 Dougall Avenue Unit 4	N9A 4P7		
	483 Dougall Avenue	N9A 4P7		
	489 Dougall Avenue	N9A 4P7		
	497 Dougall Ave –FLR 1	N9A 4P7		
	497 Dougall Ave –FLR 2	N9A 4P7		
	503 Dougall Ave- FLR 1	N9A 4P7		
	505 Dougall Ave –FLR 2	N9A 4P7		
	511 Dougall Avenue	N9A 4P7		
	515 Dougall Avenue	N9A 4P7		
	519 Dougall Avenue	N9A 4P7		
	527 Dougall Avenue	N9A 4P7		
	537 Dougall Ave – Tenant 1	N9A 4P7		
	537 Dougall Ave – Tenant 2	N9A 4P7		
	547 Dougall Ave – Tenant 1	N9A 4P7		
	547 Dougall Ave – Tenant 2	N9A 4P7		
	547 Dougall Ave – Tenant 3	N9A 4P7		
	555 Dougall Ave –Tenant 1	N9A 4P7		
	555 Dougall Ave – Tenant 2	N9A 4P7		
	555 Dougall Ave – Tenant 3	N9A 4P7		
	555 Dougall Ave – Tenant 4	N9A 4P7		
	563 Dougall Ave –FLR 1	N9A 4P7		
	563 Dougall Ave - FLR 2	N9A 4P7		
	320 Wyandotte Street West	N9A 5X2		
	405 Dougall Avenue	N/A		
	465 Dougall Avenue	N9A 4P7		
	496 Dougall Avenue	N9A 4P6		
	504 Dougall Avenue	N9A 4P6		
	508 Dougall Avenue	N9A 4P6		
	516 Dougall Avenue	N9A 4P6		
	526 Dougall Avenue – Tenant 1	N9A 4P6		
	526 Dougall Avenue – Tenant 2	N9A 4P6		
	532 Dougall Avenue – Front Unit	N9A 4P6		
	532 Dougall Avenue – Rear Unit	N9A 4P6		
	542 Dougall Avenue	N9A 4P6		
	548 Dougall Avenue	N9A 4P6		
	554 Dougall Avenue	N9A 4P6		
	570 Dougall Avenue	N9A 4P6		
	562 Dougall Avenue – FLR 1	N9A 4P6		
	562 Dougall Avenue – FLR 2	N9A 4P6		
	592 Dougall Avenue	N9A 4P6		
	401 Park Street	N9A 5V4		
	427 Church Street	N/A		
	437 Church Street	N9A 4T1		
	457 Church Street – Unit 1	N9A 4T1		
	457 Church Street – Unit 4	N9A 4T1		
	459 Church Street – Unit 2	N9A 4T1		
	459 Church Street – Unit 3	N9A 4T1		
	463 Church Street- Tenant 1	N9A 4T1		
	463 Church Street – Rear Unit	N9A 4T1		
	481 Church Street	N9A 4T1		
	485 Church Street – FLR 1	N9A 4T1		

485 Church Street - FLR 2	N9A 4T1		
491 Church Street - Tenant 1	N9A 4T1		
491 Church Street - Tenant 2	N9A 4T1		
491 Church Street - Tenant 3	N9A 4T1		
491 Church Street - Tenant 4	N9A 4T1		
509 Church Street - FLR 1	N9A 4T2		
511 Church Street - FLR 2	N9A 4T2		
521 Church Street - FLR 1	N9A 4T2		
521 Church Street FLR 2	N9A 4T2		
517 Church Street - FLR 1	N9A 4T2		
517 Church Street - FLR 2	N9A 4T2		
517 Church Street -Bsmnt	N9A 4T2		
527 Church Street - FLR 1	N9A 4T2		
527 Church Street - FLR 1	N9A 4T2		
527 Church Street - FLR 2	N9A 4T2		
527 Church Street - FLR 3	N9A 4T2		
533 Church Street - Tenant 1	N9A 4T2		
533 Church Street - Tenant 2	N9A 4T2		
533 Church Street - Tenant 3	N9A 4T2		
533 Church Street - Tenant 4	N9A 4T2		
533 Church Street - Tenant 5	N9A 4T2		
533 Church Street - Tenant 6	N9A 4T2		
539 Church Street - FLR 1	N9A 4T2		
539 Church Street - FLR 3	N9A 4T2		
545 Church Street - FLR 1	N/A		
545 Church Street - FLR 2	N/A		
545 Church Street - FLR 3	N/A		
561 Church Street - FLR 1	N9A 4T3		
561 Church Street - FLR 2	N9A 4T3		
567 Church Street	N9A 4T3		
579 Church Street	N9A 4T3		
402 Wyandotte Street West	N9A 5X4		
406 Wyandotte Street West	N9A 5X4		
406 Church Street	N9A 4S9		
412 Church Street - FLR 1	N9A 4S9		
412 Church Street - Tenant 1	N9A 4S9		
412 Church Street - Tenant 2	N9A 4S9		
420 Church Street	N9A 4S9		
426 Church Street	N9A 4S9		
434 Church Street	N9A 4S9		
442 Church Street	N9A 4S9		
450 Church Street	N9A 4S9		
454 Church Street - FLR 1	N9A 4S9		
454 Church Street - FLR 2	N9A 4S9		
462 Church Street	N9A 4S9		
470 Church Street - Tenant 1	N9A 4S9		
470 Church Street - Tenant 2	N9A 4S9		
470 Church Street - Tenant 3	N9A 4S9		
478 Church Street	N9A 4S9		
488 Church Street	N9A 4S9		
494 Church Street - FLR 1	N9A 4S9		
494 Church Street - FLR 2	N9A 4S9		
502 Church Street	N9A 4S9		
508 Church Street	N9A 4S9		
518 Church Street -Unit 1	N9A 4S9		

	518 Church Street –Unit 2	N9A 4S9		
	518 Church Street –Unit 3	N9A 4S9		
	520 Church Street –FLR 1	N9A 4S9		
	520 Church Street –FLR 2	N9A 4S9		
	528 Church Street –FLR 1	N9A 4S9		
	528 Church Street –FLR 2	N9A 4S9		
	536 Church Street	N9A 4S9		
	542 Church Street	N9A 4S9		
	548 Church Street – FLR 1	N9A 4S9		
	548 Church Street – FLR 2	N9A 4S9		
	552 Church Street	N9A 4S9		
	562 Church Street	N9A 4S9		
	570 Church Street	N9A 4S9		
	576 Church Street	N9A 4S9		
	366 Wyandotte Street West	N9A 5X2		
	LOT Church Street – Lot south of MN 478			
	LOT Dougall – Lot North of MN 455			
	LOT Church Street –Lot south of 401 Park St			
	LOT Church Street – Lot south of 437 Church St.			
	LOT Church Street –Lot North of 481 Church St			

AMENDMENTS TO PARKING BY LAW 9023
APPENDIX "A"

ITEM	REGULATION	STREET	DESCRIPTION AND LOCATION				REASON	
1	Schedule "GG" Relating to On street Parking Areas ADD	Church Street	Area	Street and Portions of Street	Parking Limit - Time and Day	During the months of April, June, August and October	Number of Permits per Household	Successful Petition
			12	Church Street from Park Street to Wyandotte Street West	24 hours - Monday through Sunday	West Side East Side	At Executive Director of Operations discretion	
2	Schedule "GG" Relating to On street Parking Areas ADD	Dougall Avenue	Area	Street and Portions of Street	Parking Limit - Time and Day	During the months January through December	Number of Permits per Household	Successful Petition
			12	Dougall Avenue from Park Street to Wyandotte Street West	24 hours - Monday through Sunday	West side	At Executive Director of Operations discretion	

APPENDIX "B"



THE CORPORATION OF THE CITY OF WINDSOR
OFFICE OF THE CITY ENGINEER

Mario Sonego, P. Eng.,
City Engineer
1266 McDougall Street
Windsor, Ontario, N8X 3M7
(519) 255-6248 Fax (519) 973-5476
msonego@city.windsor.on.ca

February 22, 2011

Frank Degasperis
563 Dougall Avenue
Windsor, Ontario
N9A 4P7

Dear Mr. Degasperis:

RE: PERMIT PARKING – DOUGALL AVENUE AND CHURCH STREET

Further to your request, please find enclosed a petition we have prepared to determine neighbourhood acceptance of permit parking on Dougall Avenue and Church Street.

Please circulate this petition to the residents and/or businesses in this area. The signatures must be completed on the attached petition forms and each signature must be witnessed by the person circulating the petitions. A property owner cannot witness his or her own signature. All signatures on the petition must be written, printing not acceptable.

Should you be successful in obtaining 95% of the signatures requested on this petition, please return it to this Department accordingly. A sufficiently signed petition does not guarantee the proposed changes, however it does ensure that a report will be sent to Council for their consideration.

If you have any questions and/or concerns, please do not hesitate to contact Angelo Calcara, Transportation Technologist at 519-255-6247, ext. 6102 at your convenience.

Yours truly,

J. Eugeni, P. Eng.,
Manager of Transportation Planning
AC/pg
Attachment

c.c. Transportation Technologist
Councillor Valentinis
PETITION Degasperis Dougall and Church

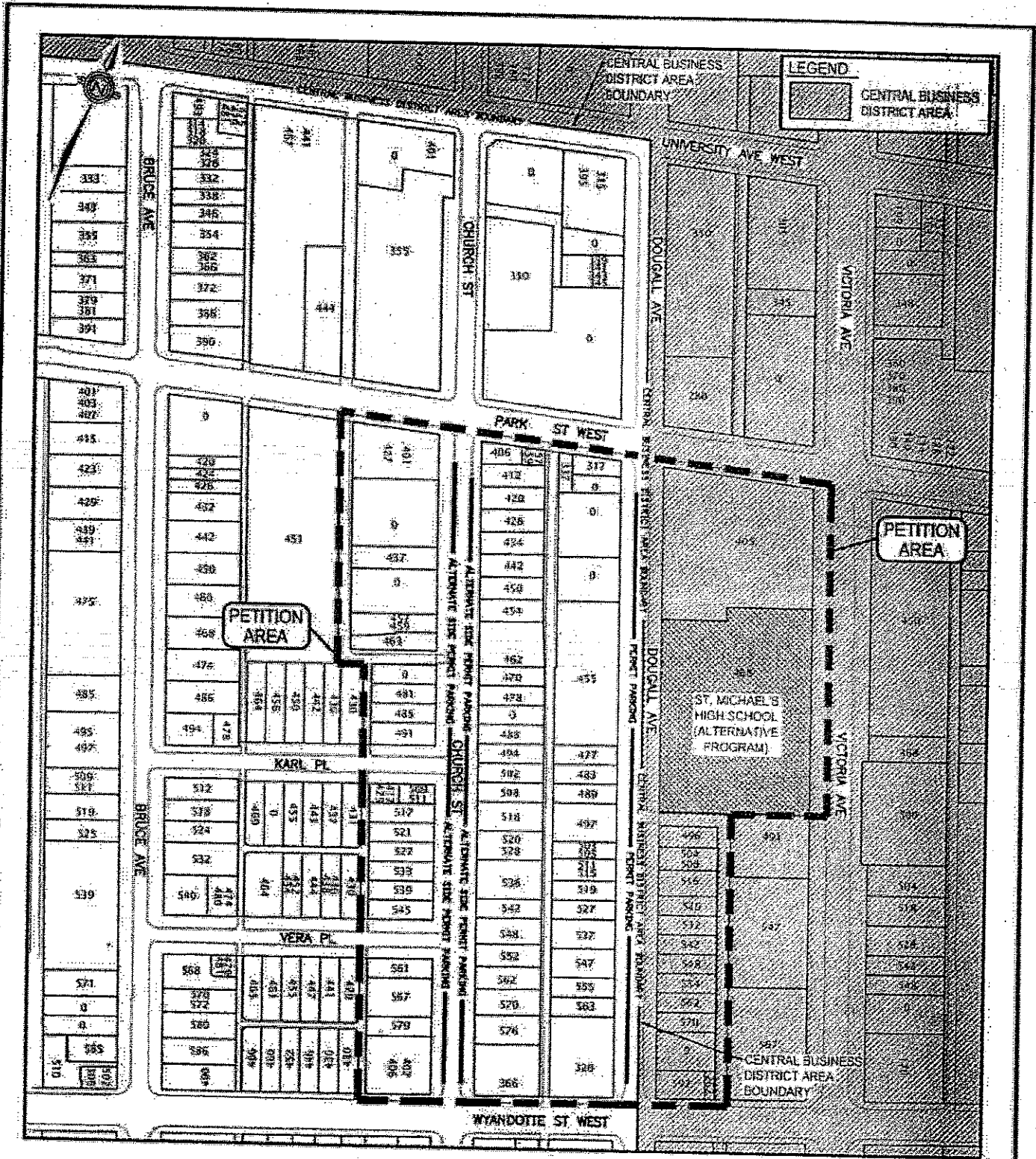

THE CORPORATION OF THE CITY OF WINDSOR – ENGINEERING DEPARTMENT

**RESIDENTIAL PERMIT PARKING
CHURCH STREET & DOUGALL AVENUE**

Marian Drouillard
Marian Drouillard, Manager of Geomatics

SCALE: N.T.S.
DWN BY: AP

DATE: JUNE 2012
CHECKED BY: PJJ/SG

DWG. NO.
C-3152

CRISANTE DE GASPERIS

Copy

Street	Point Name	Signature	Date	Witness Signature	Date
Dougall Ave - Tenant 1	CRISANTE DE GASPERIS	<i>[Signature]</i>	03/21/11	Elma De Gasperis	
Dougall Ave - Tenant 2	Ch. Toufikou Ahmed	<i>[Signature]</i>	03/21/11	Frank De Gasperis	
Dougall Ave - Tenant 3	CRISANTE DE GASPERIS	<i>[Signature]</i>	03-21-11 X		
Dougall Ave - Tenant 4	ATIF ELAMIN	<i>[Signature]</i>	03-21-11	Frank De Gasperis	
Dougall Ave - FLR 1 + Dougall Ave - FLR 2 + Wyandotte Street West (Manager of Store)	DAVE LOCKE	<i>[Signature]</i>	03/21/11	Elma De Gasperis	
Dougall Avenue (Owner or Principal)	X ANTHONY DELLIS	<i>[Signature]</i>	03/21/11	Elma De Gasperis	
Dougall Avenue	JOHN SYROPOULOS	<i>[Signature]</i>	03/21/11	Elma De Gasperis	
Dougall Avenue	GEORGE YANG	<i>[Signature]</i>	03/21/11	Elma De Gasperis	
Dougall Avenue	OWEN R	<i>[Signature]</i>	03/21/11	Elma De Gasperis	
Dougall Avenue	GEORGE YANG	<i>[Signature]</i>	03/21/11	Elma De Gasperis	
Dougall Avenue	WANG LALI	<i>[Signature]</i>	03/21/11	Elma De Gasperis	
Dougall Ave - Tenant 1	WILSON BUIES	<i>[Signature]</i>	03/21/11	Elma De Gasperis	
Dougall Ave - Tenant 2	PETER SUBERMAN	<i>[Signature]</i>	03/21/11	Elma De Gasperis	
Dougall Ave - Front Unit	OWNER				
Dougall Ave - Rear Unit					
Dougall Avenue	LIT HUNG CHUK	<i>[Signature]</i>		Elma De Gasperis	
Dougall Avenue	FAI YEN MIEHA	<i>[Signature]</i>		59-977-7615	
Dougall Avenue	TIA YEN LEE	<i>[Signature]</i>			

*Original
Signature
Property Address
John*

2/1/11

CURTAIN REGULATIONS:

- "ALTERNATE SIDE PARKING" - Church Street - West/East Sides - From University Avenue to Mill Street
- "NO PARKING ON" - Dougall Avenue - East Side - From Park Street to a point 75 meters south of Park Street
- "NO PARKING ON" - Dougall Avenue - East Side - From a point 100 meters south of Park Street to Wyandotte Street
- "NO STOPPING OR PARKING" - Dougall Avenue - East Side - From a point 75 meters south of Park Street to a point 160 meters south of Park Street

Proposed Resolutions:

- ADD - "Residential Permit Parking" - Church Street - West/East Sides - From Park Street West to Wyandotte Street West
- ADD - "Residential Permit Parking" - Dougall Avenue - West Side - From Park Street West to Wyandotte Street West

PLEASE NOTE:

ONE SIGNATURE REQUIRED PER HOUSEHOLD AND/OR BUSINESS.
THIS PETITION IS BEING CIRCULATED TO DETERMINE NEIGHBOURHOOD ACCEPTANCE.

BRISANTE DE BASPERIS

#	Street	Post Name	Signature	Date	Witness Signature	Date
534	Douglass Ave - Tenant 1	Brisante De Basperis	[Signature]	03/11/11	Clara De Goyens	03/11/11
535	Douglass Ave - Tenant 2	Rubel Asgoban	[Signature]	03/11/11	Clara De Goyens	03/11/11
	Douglass Ave - Tenant 3	Ch. Tambay Ahmad	[Signature]	03/11/11	Frank De Goyens	03/11/11
	Douglass Ave - Tenant 4					
568	Douglass Ave - FLR 1	BRISANTE DE BASPERIS	[Signature]	03-01-11	Frank De Goyens	03-01-11
	Douglass Ave - FLR 2	AIEF ELAMIN	[Signature]	03-02-11	Frank De Goyens	03-02-11
320	Wyndolite Street West (Manager of Store)	Continental Bank of Canada	[Signature]	04/11/11	Frank De Goyens	04/15/11
455	Douglass Avenue					
460	Douglass Avenue (Owner or Principal)	X Arlene Nolas	[Signature]	03/21/11	Clara De Goyens	03/22/11
466	Douglass Avenue	JOHN SPYROPOLOS	[Signature]	03/17/11	Clara De Goyens	03/17/11
504	Douglass Avenue	YONG	[Signature]	03/11/11	Clara De Goyens	03/11/11
508	Douglass Avenue	YONG	[Signature]	03/11/11	Clara De Goyens	03/11/11
516	Douglass Avenue	YONG	[Signature]	03/11/11	Clara De Goyens	03/11/11
526	Douglass Ave - Tenant 1					
	Douglass Ave - Tenant 2					
532	Douglass Ave - Front Unit	PETER SUBERMAN	[Signature]	03/11/11	Clara De Goyens	03/11/11
	Douglass Ave - Rear Unit					
542	Douglass Avenue					
548	Douglass Avenue	LIT HUNG CHUK	[Signature]	03/11/11	Clara De Goyens	03/11/11
554	Douglass Avenue	LEE	[Signature]	03/11/11	Clara De Goyens	03/11/11
560	Douglass Avenue	TIN YEN LEE	[Signature]	03/11/11	Clara De Goyens	03/11/11

Current Regulations:

Proposed Regulations:

PLEASE NOTE:

ONE SIGNATURE REQUIRED PER HOUSEHOLD AND/OR BUSINESS. THIS PETITION IS BEING CIRCULATED TO DETERMINE NEIGHBOURHOOD ACCEPTANCE.

"ALTERNATE SIDE PARKING" - Church Street - West End Station - From University Avenue to Ellet Street
 "NO PARKING ON" - Douglas Avenue - East Side - From Park Street to a point 75 meters south of Park Street
 "NO PARKING OFF" - Douglas Avenue - East Side - From a point 150 meters south of Park Street to Wyndolite Street
 "NO STOPPING OR PARKING" - Douglas Avenue - East Side - From a point 75 meters south of Park Street to a point 150 meters south of Park Street

ADD - "Residential Permit Parking" - Church Street - West End Station - From Park Street West to Wyndolite Street West
 ADD - "Residential Permit Parking" - Douglas Avenue - West Side - From Park Street West to Wyndolite Street West

Handwritten signature/initials in the top right corner.

Address	Street	Field Name	Signature	Date	Witness Signature	Date
502	Dougal Ave - FLR 1	SAYED BALUCHI	Sayed	3-10-11	602 P.S.U.	3-7-11
502	Dougal Ave - FLR 2	JOMNER	Jomner			
502	Dougal Avenue	LIZ BURNS	Liz Burns	3/10/11	Charles D. Payne	3/11/11
401	Park Street					
427	Church Street					
437	Church Street					
457	Church Street - Unit 1					
459	Church Street - Unit 4					
	Church Street - Unit 2					
	Church Street - Unit 3					
463	Church Street - Tenant 1					
481	Church Street - Rear Unit	ROY BAKER	Roy Baker	3/11/11	Liz Burns	3/11/11
485	Church Street - FLR 1					
	Church Street - FLR 2					
	Church Street - Tenant 1					
	Church Street - Tenant 2					
491	Church Street - Tenant 3					
	Church Street - Tenant 4					
509	Church Street - FLR 1					
511	Church Street - FLR 2					
521	Church Street - FLR 1					
	Church Street - FLR 2					

Current Regulations

- *"ALTERNATE SIDE PARKING" - Church Street - West/East Sides - From University Avenue to Etloe Street
- *"NO PARKING ON" - Dougal Avenue - East Side - From Park Street to a point 75 meters south of Park Street
- *"NO PARKING ON" - Dougal Avenue - East Side - From a point 100 meters south of Park Street to Wyandotte Street
- *"NO STOPPING OR PARKING" - Dougal Avenue - East Side - From a point 78 meters south of Park Street to a point 100 meters south of Park Street

Proposed Regulations

- ADD - "Residential Permit Parking" - Church Street - West/East Sides - From Park Street West to Wyandotte Street West
- ADD - "Residential Permit Parking" - Dougal Avenue - West Side - From Park Street West to Wyandotte Street West

PLEASE NOTE:

ONE SIGNATURE REQUIRED PER HOUSEHOLD AND/OR BUSINESS.
THIS PETITION IS BEING CIRCULATED TO DETERMINE NEIGHBOURHOOD ACCEPTANCE.

166-6474

Handwritten signature/initials

Address	Unit	Permit Name	Signature	Date	Where Stamped	Days
Douglas Ave - FLR 1		SAVED SCHULZ	SCHULZ	5/10/11	502-255-8	5/10/11
Douglas Ave - FLR 2						
Douglas Avenue		Liz Adams		5/10/11		
Park Street		Geo Leonard		5/10/11		
Church Street		S Church Board				
Church Street		S Church Board				
Church Street - Unit 1		Nicole Brassinger		5/10/11		
Church Street - Unit 4		Jody Hornak		5/10/11		
Church Street - Unit 2		Brian Barnett		5/10/11		
Church Street - Unit 3		Kenya Knight		5/10/11		
Church Street - Tenant 1		USMAIA KAM		5/10/11		
Church Street - Rear Link		ANASTASIA WOODWARD		5/10/11		
Church Street		AND BAKER		5/10/11		
Church Street - FLR 1		Laura Peters		5/10/11		
Church Street - FLR 2		ANASTASIA WOODWARD		5/10/11		
Church Street - Tenant 1		KAROL FELICIA		5/15/11		
Church Street - Tenant 2		W/L LIVES				
Church Street - Tenant 3		Ken Hall		5/15/11		
Church Street - Tenant 4		RANDALL ECKER		5/15/11		
Church Street - FLR 1		Maria Day Ho		5/16/11		
Church Street - FLR 2		Maria Day Ho		5/16/11		
Church Street - FLR 1		Matt Amerline		5/16/11		
Church Street - FLR 2		FRANK SCHULZ		5/16/11		

ALTERNATE SIDE PARKING: From Park Street West to Myrtle Street, East of Church Street, From Park Street West to Myrtle Street, East of Church Street.
 NO PARKING ON - Douglas Avenue, East Side, From Park Street West to Myrtle Street, East of Church Street.
 NO PARKING ON - Douglas Avenue, East Side, From a point 100 feet south of Park Street to Myrtle Street.
 NO STOPPING OR PARKING - Douglas Avenue, East Side, From a point 75 feet south of Park Street to a point 100 meters south of Park Street.

ADD - "Residential Permit Parking" - Church Street - West/East Side, From Park Street West to Myrtle Street West
 ADD - "Residential Permit Parking" - Douglas Avenue - West Side - From Park Street West to Myrtle Street West

ONE SIGNATURE REQUIRED PER HOUSEHOLD AND/OR BUSINESS.
 THIS PETITION IS BEING CIRCULATED TO DETERMINE NEIGHBOURHOOD ACCEPTANCE.

PLEASE NOTE:

115

#	Street	Permit Name	Signature	Date	Witness Signature	Date
517	Church Street - FLR 1					
	Church Street - FLR 2					
	Church Street - Bermit					
	Church Street - FLR 1	Joseph C. B. Smith	[Signature]	April 1, 2011	Clara De G... [Signature]	April 1, 2011
527	Church Street - FLR 1					
	Church Street - FLR 2					
	Church Street - FLR 3					
	Church Street - Tenant 1					
	Church Street - Tenant 2					
	Church Street - Tenant 3					
	Church Street - Tenant 4					
	Church Street - Tenant 5					
	Church Street - Tenant 6					
539	Church Street - FLR 1					
	Church Street - FLR 3					
545	Church Street - FLR 1	Tony-Dawalibi	[Signature]	April 1, 2011	[Signature]	April 1, 2011
	Church Street - FLR 2	O'Ware	[Signature]			
	Church Street - FLR 3	[Signature]				
561	Church Street - FLR 1	Witness on form on hand	[Signature]	4/5/11	[Signature]	4/5/11
	Church Street - FLR 2					
567	Church Street	PAUL MICHEL	[Signature]	4/5/11	[Signature]	4/5/11

Current Regulations:

- *ALTERNATE SIDE PARKING* - Church Street - West/East Sides - From University Avenue to Elicit Street
- *NO PARKING ON* - Douglas Avenue - East Side - From Park Street to a point 75 meters south of Park Street
- *NO PARKING ON* - Douglas Avenue - East Side - From a point 100 meters south of Park Street to Wyandale Street
- *NO STOPPING OR PARKING* - Douglas Avenue - East Side - From a point 75 meters south of Park Street to a point 100 meters south of Park Street

Proposed Regulations:

- ADD - "Residential Permit Parking" - Church Street - West/East Sides - From Park Street West to Wyandale Street West
- ADD - "Residential Permit Parking" - Douglas Avenue - West Side - From Park Street West to Wyandale Street West

PLEASE NOTE:

ONE SIGNATURE REQUIRED PER HOUSEHOLD AND/OR BUSINESS.
THIS PETITION IS BEING CIRCULATED TO DETERMINE NEIGHBOURHOOD ACCEPTANCE.

6/11/11

#	Street	Tenant Name	Signature	Date	Phone Number	Other
512	Church Street - FLR 1	D. GUILDOLIN	<i>[Signature]</i>	3/10/11		310/111
	Church Street - FLR 2	A. SEPICE	<i>[Signature]</i>	3/10/11		310/111
	Church Street - Basement	A. HERRICK	<i>[Signature]</i>	3/10/11		310/111
	Church Street - FLR 1		<i>[Signature]</i>	3/10/11		310/111
	Church Street - FLR 1		<i>[Signature]</i>	3/10/11		310/111
	Church Street - FLR 2		<i>[Signature]</i>	3/10/11		310/111
	Church Street - FLR 3		<i>[Signature]</i>	3/10/11		310/111
	Church Street - Tenant 1		<i>[Signature]</i>	3/10/11		310/111
	Church Street - Tenant 2		<i>[Signature]</i>	3/10/11		310/111
	Church Street - Tenant 3		<i>[Signature]</i>	3/10/11		310/111
	Church Street - Tenant 4		<i>[Signature]</i>	3/10/11		310/111
	Church Street - Tenant 5		<i>[Signature]</i>	3/10/11		310/111
	Church Street - Tenant 6		<i>[Signature]</i>	3/10/11		310/111
	Church Street - FLR 1		<i>[Signature]</i>	3/10/11		310/111
	Church Street - FLR 2		<i>[Signature]</i>	3/10/11		310/111
	Church Street - FLR 3		<i>[Signature]</i>	3/10/11		310/111
	Church Street - FLR 1		<i>[Signature]</i>	3/10/11		310/111
	Church Street - FLR 2		<i>[Signature]</i>	3/10/11		310/111
	Church Street		<i>[Signature]</i>	3/10/11		310/111

ALTERNATE SIDE PARKING: Church Street - West/East Side - From University Avenue to Blue Street
 NO PARKING ON: Douglas Avenue - East Side - From Park Street to a point 75 meters south of Park Street
 NO PARKING ON: Douglas Avenue - East Side - From a point 100 meters north of Park Street to Wynndale Street
 NO STOPPING OR PARKING: Douglas Avenue - East Side - From a point 75 meters south of Park Street to a point 100 meters south of Park Street

ADD: Residential Permit Parking - Church Street - West/East Side - From Park Street West to Wynndale Street West
 ADD: Residential Permit Parking - Douglas Avenue - West Side - From Park Street West to Wynndale Street West

PLEASE NOTE:
 ONE SIGNATURE REQUIRED PER HOUSEHOLD AND/OR BUSINESS.
 THIS PETITION IS BEING CIRCULATED TO DETERMINE NEIGHBOURHOOD ACCEPTANCE.

#	Street	Prop Name	Signature	Date	Vehicle Type/Color	Date
379	Church Street	Wesley	[Signature]	12/18/11		
402	Wyandotte Street West	Bill [Signature]	[Signature]	12/18/11	Emergency	12/18/11
406	Church Street	Albert [Signature]	[Signature]	12/18/11		
412	Church Street - FLR 1	Wesley	[Signature]	12/18/11		
412	Church Street - Tenant 1	Wesley	[Signature]	12/18/11		
420	Church Street - Tenant 2	Wesley	[Signature]	12/18/11		
420	Church Street	Frank	[Signature]	12/18/11		
426	Church Street	Bernie Bonny	[Signature]	12/18/11		
434	Church Street	Alexandra [Signature]	[Signature]	12/18/11		
442	Church Street	Arthur Barnett	[Signature]	12/18/11		
450	Church Street	[Signature]	[Signature]	12/18/11		
454	Church Street - FLR 1	[Signature]	[Signature]	12/18/11		
454	Church Street - FLR 2	[Signature]	[Signature]	12/18/11		
462	Church Street	Paul [Signature]	[Signature]	12/18/11		
462	Church Street - Tenant 1	Paul [Signature]	[Signature]	12/18/11		
470	Church Street - Tenant 2	Paul [Signature]	[Signature]	12/18/11		
470	Church Street - Tenant 3	Paul [Signature]	[Signature]	12/18/11		
478	Church Street	Leonard Sprange	[Signature]	12/18/11		
488	Church Street	[Signature]	[Signature]	12/18/11		
494	Church Street - FLR 1	Stephanie [Signature]	[Signature]	12/18/11		
494	Church Street - FLR 2	Stephanie [Signature]	[Signature]	12/18/11		
502	Church Street	[Signature]	[Signature]	12/18/11		

all over the street

12/18/11

ALTERNATE SIDE PARKING - Church Street - West/East Side - From University Avenue to End Street
 NO PARKING ON - Douglas Avenue - East Side - From Park Street to a point 75 meters south of Park Street
 NO PARKING ON - Douglas Avenue - East Side - From a point 100 meters south of Park Street to Wyandotte Street
 NO STOPPING OR PARKING - Douglas Avenue - East Side - From a point 75 meters south of Park Street to a point 100 meters south of Park Street
 ADD - "Bicycle Parking" - Church Street - West/East Sides - From Park Street West to Wyandotte Street West
 ADD - "Bicycle Parking" - Douglas Avenue - West Side - From Park Street West to Wyandotte Street West

**ONE SIGNATURE REQUIRED PER HOUSEHOLD AND/OR BUSINESS.
 THIS PETITION IS BEING CIRCULATED TO DETERMINE NEIGHBOURHOOD ACCEPTANCE.**

PLEASE NOTE

#	Street	Front Facing	Signature	Title	Witness Signature	Date
579	Church Street					
402	Wyandotte Street West					
406	Church Street	Volunteer of the church				
412	Church Street - FLR 1					
	Church Street - Tenant 1					
	Church Street - Tenant 2					
420	Church Street					
428	Church Street					
434	Church Street					
442	Church Street					
450	Church Street	Church Street				
454	Church Street - FLR 1	Church Street				
	Church Street - FLR 2	Church Street				
462	Church Street					
	Church Street - Tenant 1					
470	Church Street - Tenant 2					
	Church Street - Tenant 3					
478	Church Street	Church Street				
488	Church Street	Church Street				
494	Church Street - FLR 1					
	Church Street - FLR 2					
502	Church Street					

Current Regulations:

- *ALTERNATE SIDE PARKING* - Church Street - West/East Sides - From University Avenue to Elled Street
- *NO PARKING ON* - Douglas Avenue - East Side - From Park Street to a point 75 meters south of Park Street
- *NO PARKING ON* - Douglas Avenue - East Side - From a point 150 meters south of Park Street to Wyandotte Street
- *NO STOPPING OR PARKING* - Douglas Avenue - East Side - From a point 75 meters south of Park Street to a point 100 meters south of Park Street

Proposed Regulations:

- ADD: *Residential Permit Parking* - Church Street - West/East Sides - From Park Street West to Wyandotte Street West
- ADD: *Residential Permit Parking* - Douglas Avenue - West Side - From Park Street West to Wyandotte Street West

PLEASE NOTE: ONE SIGNATURE REQUIRED PER HOUSEHOLD AND/OR BUSINESS. THIS PETITION IS BEING CIRCULATED TO DETERMINE NEIGHBOURHOOD ACCEPTANCE.

Handwritten signature/initials

Block	Property Name	Signature	Date	Witness Signature	Date
508	Church Street	[Signature]	[Date]	[Signature]	[Date]
510	Church Street - Unit 1	[Signature]	[Date]	[Signature]	[Date]
512	Church Street - Unit 2	[Signature]	[Date]	[Signature]	[Date]
514	Church Street - Unit 3	[Signature]	[Date]	[Signature]	[Date]
516	Church Street - FLR 1	[Signature]	[Date]	[Signature]	[Date]
518	Church Street - FLR 2	[Signature]	[Date]	[Signature]	[Date]
520	Church Street - FLR 1	[Signature]	[Date]	[Signature]	[Date]
522	Church Street - FLR 2	[Signature]	[Date]	[Signature]	[Date]
524	Church Street	[Signature]	[Date]	[Signature]	[Date]
526	Church Street - FLR 1	[Signature]	[Date]	[Signature]	[Date]
528	Church Street - FLR 2	[Signature]	[Date]	[Signature]	[Date]
530	Church Street	[Signature]	[Date]	[Signature]	[Date]
532	Church Street	[Signature]	[Date]	[Signature]	[Date]
534	Church Street	[Signature]	[Date]	[Signature]	[Date]
536	Church Street	[Signature]	[Date]	[Signature]	[Date]
538	Church Street	[Signature]	[Date]	[Signature]	[Date]
540	Church Street	[Signature]	[Date]	[Signature]	[Date]
542	Church Street	[Signature]	[Date]	[Signature]	[Date]
544	Church Street	[Signature]	[Date]	[Signature]	[Date]
546	Church Street	[Signature]	[Date]	[Signature]	[Date]
548	Church Street	[Signature]	[Date]	[Signature]	[Date]
550	Church Street	[Signature]	[Date]	[Signature]	[Date]
552	Church Street	[Signature]	[Date]	[Signature]	[Date]
554	Church Street	[Signature]	[Date]	[Signature]	[Date]
556	Church Street	[Signature]	[Date]	[Signature]	[Date]
558	Church Street	[Signature]	[Date]	[Signature]	[Date]
560	Church Street	[Signature]	[Date]	[Signature]	[Date]
562	Church Street	[Signature]	[Date]	[Signature]	[Date]
564	Church Street	[Signature]	[Date]	[Signature]	[Date]
566	Church Street	[Signature]	[Date]	[Signature]	[Date]
568	Church Street	[Signature]	[Date]	[Signature]	[Date]
570	Church Street	[Signature]	[Date]	[Signature]	[Date]
572	Church Street	[Signature]	[Date]	[Signature]	[Date]
574	Church Street	[Signature]	[Date]	[Signature]	[Date]
576	Church Street	[Signature]	[Date]	[Signature]	[Date]
578	Church Street	[Signature]	[Date]	[Signature]	[Date]
580	Church Street	[Signature]	[Date]	[Signature]	[Date]
582	Church Street	[Signature]	[Date]	[Signature]	[Date]
584	Church Street	[Signature]	[Date]	[Signature]	[Date]
586	Church Street	[Signature]	[Date]	[Signature]	[Date]
588	Church Street	[Signature]	[Date]	[Signature]	[Date]
590	Church Street	[Signature]	[Date]	[Signature]	[Date]
592	Church Street	[Signature]	[Date]	[Signature]	[Date]
594	Church Street	[Signature]	[Date]	[Signature]	[Date]
596	Church Street	[Signature]	[Date]	[Signature]	[Date]
598	Church Street	[Signature]	[Date]	[Signature]	[Date]
600	Church Street	[Signature]	[Date]	[Signature]	[Date]

ALTERNATE SIDE PARKING - Church Street - West Side - From Parkway Avenue to Erie Street.
 NO PARKING ON - Douglas Avenue - East Side - From Park Street to 157 feet 76 inches south of Park Street.
 NO PARKING ON - Douglas Avenue - East Side - From a point 180 meters south of Park Street to Wyandotte Street.
 NO STOPPING OR PARKING - Douglas Avenue - East Side - From a point 78 meters south of Park Street to a point 140 meters south of Park Street.

ADD: "Residential Permit Parking" - Church Street - West Side - From Park Street West to Wyandotte Street West
 ADD: "Residential Permit Parking" - Douglas Avenue - West Side - From Park Street West to Wyandotte Street West

ONE SIGNATURE REQUIRED PER HOUSEHOLD AND/OR BUSINESS.
THIS PETITION IS BEING CIRCULATED TO DETERMINE NEIGHBOURHOOD ACCEPTANCE.

PLEASE NOTE:

620
 176
 19/10/14

#	Street	Print Name	Signature	Date	Witness Signature	Date
508	Church Street					
	Church Street - Unit 1		<i>[Signature]</i>	10/25/11	<i>[Signature]</i>	10/25/11
616	Church Street - Unit 2		<i>[Signature]</i>	10/25/11	<i>[Signature]</i>	10/25/11
	Church Street - Unit 3					
	Church Street - FLR 1					
520	Church Street - FLR 2	Richard Casse	<i>[Signature]</i>	10/25/11	<i>[Signature]</i>	10/25/11
608	Church Street - FLR 1	Richard Casse	<i>[Signature]</i>	10/25/11	<i>[Signature]</i>	10/25/11
	Church Street - FLR 2					
539	Church Street					
542	Church Street					
548	Church Street - FLR 1					
552	Church Street - FLR 2					
552	Church Street					
562	Church Street					
570	Church Street					
576	Church Street					
308	Wyandotte Street West					
LOT	Church Street - Lot South of MN 472					
LOT	Douglas - Lot North of MN 455					
LOT	Church Street - Lot South of 401 Park St.					
LOT	Church Street - Lot South of 437 Church St.					
LOT	Church Street - Lot North of 481 Church St.					

Current Resolutions:

- *ALTERNATE SIDE PARKING* - Church Street - West/East Sides - From University Avenue to Ellet Street
- *NO PARKING ON* - Douglas Avenue - East Side - From Park Street to a point 75 meters south of Park Street
- *NO PARKING ON* - Douglas Avenue - West Side - From a point 100 meters south of Park Street to Wyandotte Street
- *NO STOPPING OR PARKING* - Douglas Avenue - East Side - From a point 75 meters south of Park Street to a point 150 meters south of Park Street

Proposed Resolutions:

- ADD - "Residential Permit Parking" - Church Street - West/East Sides - From Park Street West to Wyandotte Street West
- ADD - "Residential Permit Parking" - Douglas Avenue - West Side - From Park Street West to Wyandotte Street West

PLEASE NOTE:

ONE SIGNATURE REQUIRED PER HOUSEHOLD AND/OR BUSINESS.
THIS PETITION IS BEING CIRCULATED TO DETERMINE NEIGHBOURHOOD ACCEPTANCE.

**PETITION FOR
PERMIT PARKING
DOUGALL AVE & CHURCH STREET**

I, HENRY KSTONZ, owner of Rose Convenience Store, located
at 406 Wyandotte Street West, is in favor of the permit parking for Church St &
Dougall Ave.

Signature: *Henry Kstonz*

Phone#: 519-252-5935

Date: OCT. 27 / 11

Q/S

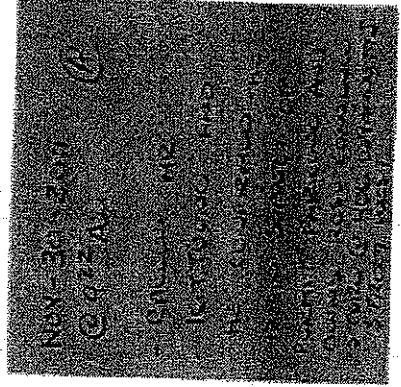

PETITION JR
PERMIT PARKING

DOUGALL AVE & CHURCH STREET

I, Huu Nguyen, ^{owner} the owner Rose City Pharmacy,

located at ¹⁴⁰⁷Wyandotte Street West, is in favor of the permit parking for Church Street
and Dougall Ave.

Signature: 

Phone: 519-252-7767

Date: 27 Oct 2011

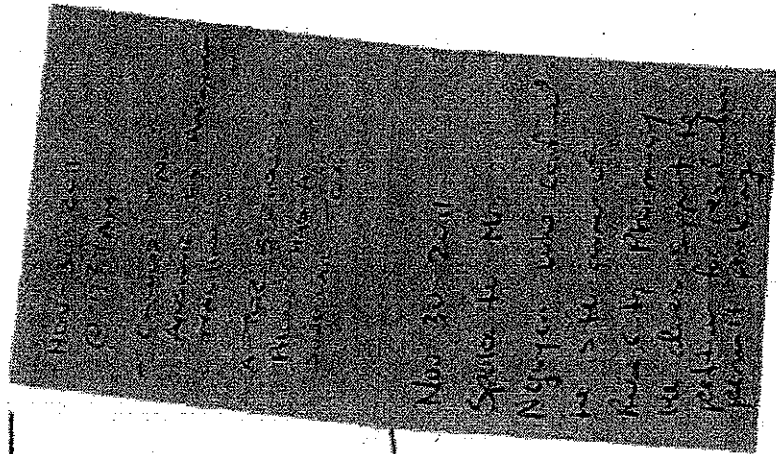



Public Works
1266 McDougall

